



Telchac Amaité

El Rostro Del Cielo



El Rostro Del Cielo

Amaité is the new and exclusive real state in development located in Telchac, one of the most exclusive ports in Yucatan, ideal to have your dream summer house so you can rest in a little piece of heaven.

It's unique natural beauty and magnificent views makes it the jewel in the crown of Yucatan.

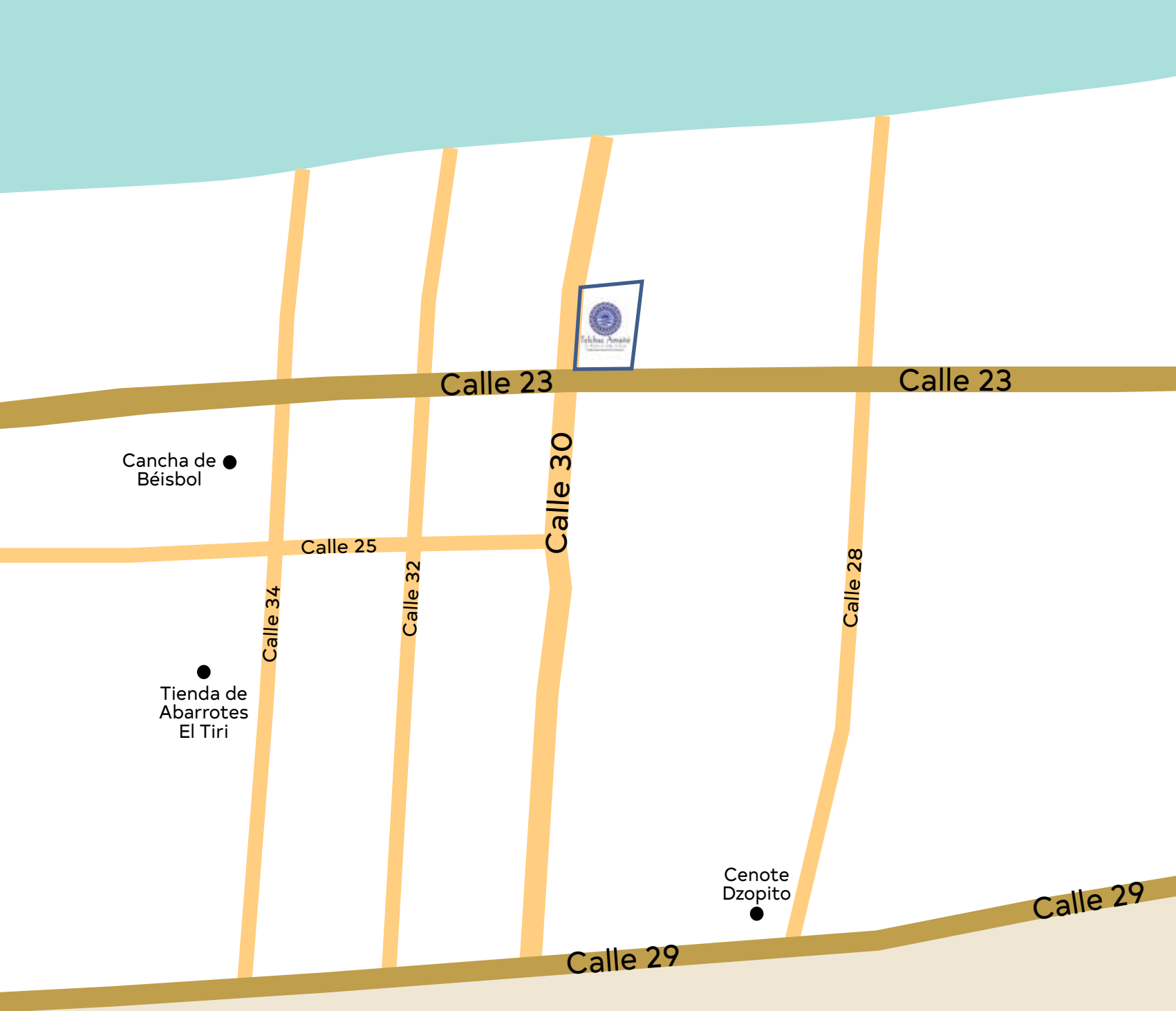

Your home on the beach

Calle 23, #121, between 28 & 30,
Centro. C.P. 97407.
Telchac Puerto, Yucatán.

Amenities



Pool.



Sunbath area



Walkways with
natural vegetation



Showers and
Toilets



Gym



Lobby



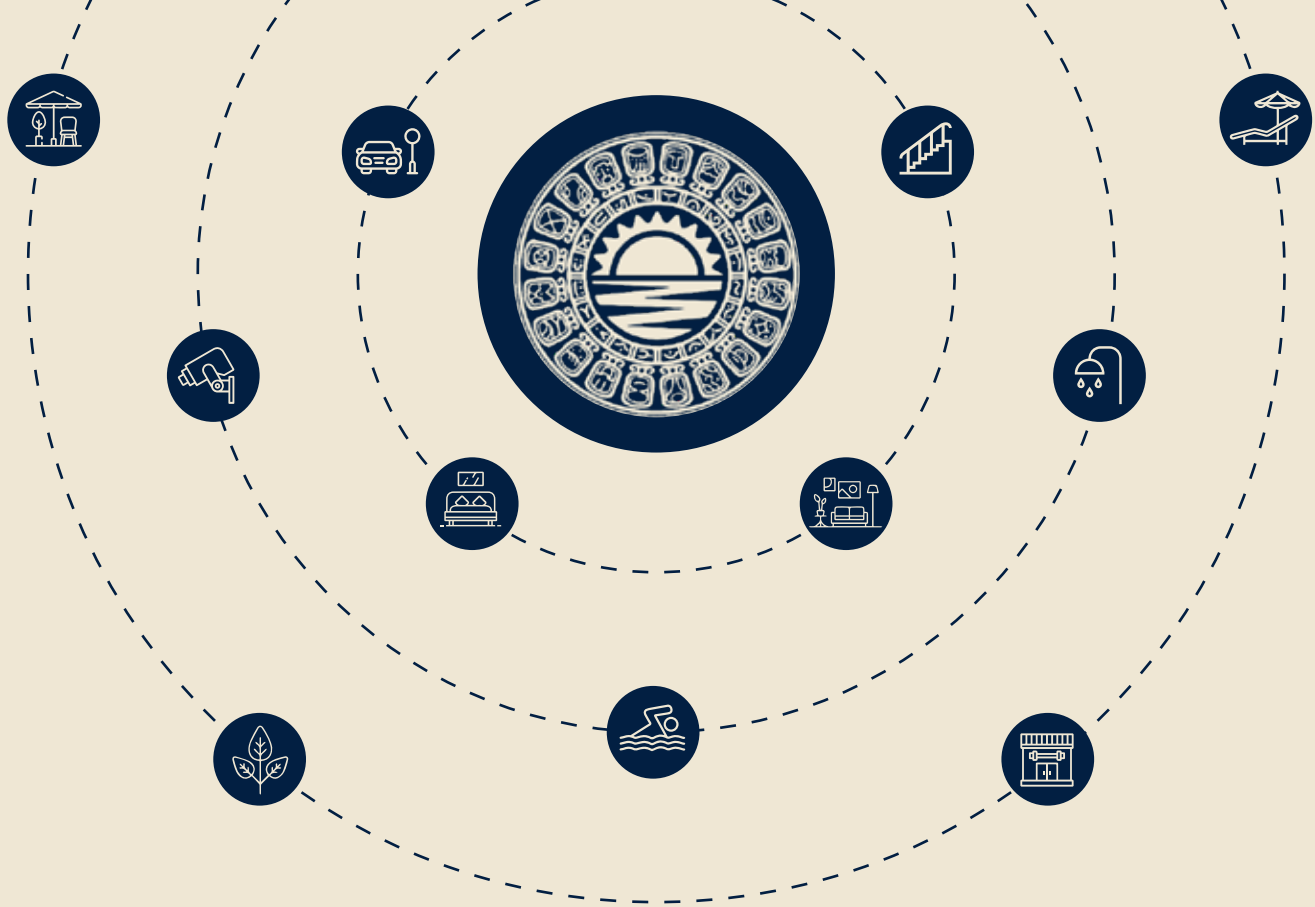

Tipologías

01

Townhouse A

DIMENSIONS

SQ. M.: 175.4 m²
Lot Size: 61.8 m²

AREAS

- 2 Parking lot
- 3 Beds
- 3 1/2 Baths

AMENITIES

- Lounge Zone
- Terrace
- Pool
- Gym
- Retail stores

02

Townhouse B

DIMENSIONS

SQ. M.: 176.62 m²
Lote Size: 61.8 m²

AREAS

- 2 Parking lot
- 3 Beds
- 3 1/2 Baths
- Grassy yard

AMENITIES

- Lounge Zone
- Terrace
- Pool
- Gym
- Retail stores

03

Townhouse C

DIMENSIONS

SQ. M.: 150.64 m²
Lote Size: 50.12 m²

AREAS

- 1 Parking lot
- 3 Beds
- 3 1/2 Baths

AMENITIES

- Lounge Zone
- Terrace
- Pool
- Gym
- Retail stores

Townhouse A

175.4 m²



LL 61.8 m²



L1 61.8 m²



L2 51.8 m²

LOW LEVEL

- Kitchen
- Dining
- Living room
- 1/2 Bath
- Parking lot

FIRST LEVEL

- 2 Beds
- 2 Baths
- Terrace

SECOND LEVEL

- 1 Bed
- 1 Bath
- Linen closet
- Rooftop-Bar

Townhouse A



EQUIPMENT



Bar-Rooftop
and jacuzzi



Electric
grill



110/220



Drinking
water



Ceramic
floors



24 hours
security



Laundry



LED
lighting



Terrace



2 Parking
lots

Townhouse B

176.62 m²

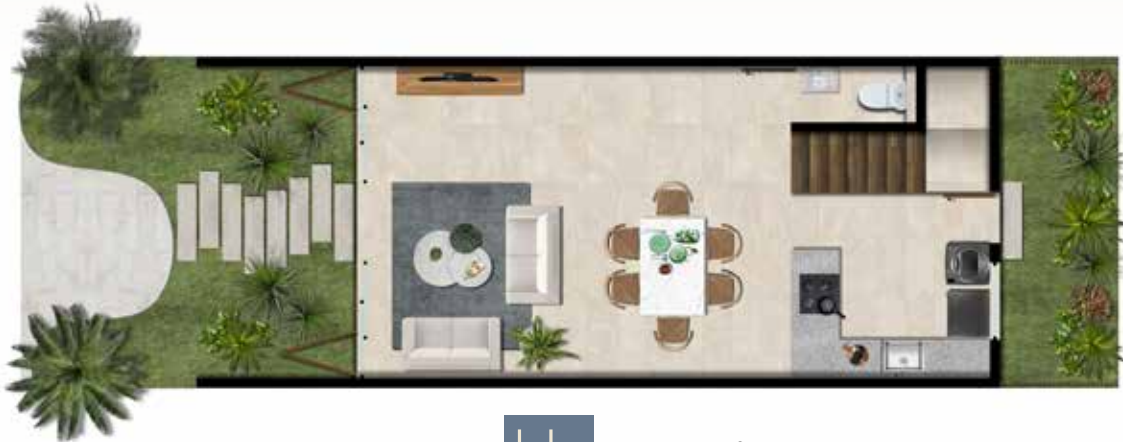

LL 62.56 m²



L1 62.56 m²



L2 51.5 m²

LOW LEVEL

- Kitchen
- Dining
- Living room
- 1/2 Bath
- Garden
- Lawn

FIRST LEVEL

- 2 Beds
- 2 Baths
- Terrace

SECOND LEVEL

- 1 Bed
- 1 Bath
- Rooftop-Bar

Townhouse B



EQUIPMENT

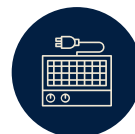

Electric grill



Lawn



110/220



Drinking water



24 hours security



Bar-Rooftop and jacuzzi



Laundry



LED lighting



Terrace



Ceramic floors



2 Parking lots

Townhouse C

150.64 m²



LL 50.12 m²

LOW LEVEL

- 1/2 Bath
- Laundry
- Kitchen
- Dining
- Living room
- Terrace



L1 47.19 m²

FIRST LEVEL

- 2 Beds
- 2 Baths



L2 53.33 m²

SECOND LEVEL

- 1 Bed
- 1 Bath
- Bar
- Rooftop

Townhouse C

EQUIPMENT



Terrace



Ceramic
floors



24 hours
security



Bar-Rooftop
and jacuzzi



Electric
grill



Drinking
water



1 Parking
lot



Laundry



LED
lighting



110/220





Telchac Amaité

El Rostro Del Cielo



LUIS G GONZALEZ

Y O U R M É R I D A R E A L E S T A T E G U I D E



Luis G González

Your Merida Real Estate Guide



www.luisgggonzalez.com



+52-984-128-4123



hola@luisgggonzalez.com