

# **LA ABUNDANCIA HOTEL LAND**

- . Area: 110.72 hectares.**
- . Beachfront: 1,152 linear meters of white sand dune beachfront.**
- . It has all the public services.**
- . Construction density: 22 keys per hectare (possible 45 keys per hectare).**
- . Total construction density: 2,436 keys**
- . Legal situation: Titled land.**
- . Cash price: \$182,700,000 USD or \$75,000 USD per the hotel key.**

**La Abundancia Hotel land is located in the municipality of Isla Blanca, the new hotel zone of Cancun, area among which the Riu Dunamar, Planet Hollywood, Majestic, Catalonia and Grand Palladium Costa Mujeres hotels are established; hotels that have the highest average annual rate of Latin America, as well as the highest average annual occupancy.**

# La Abundancia Hotel Land



# La Abundancia Hotel Land Blue Print

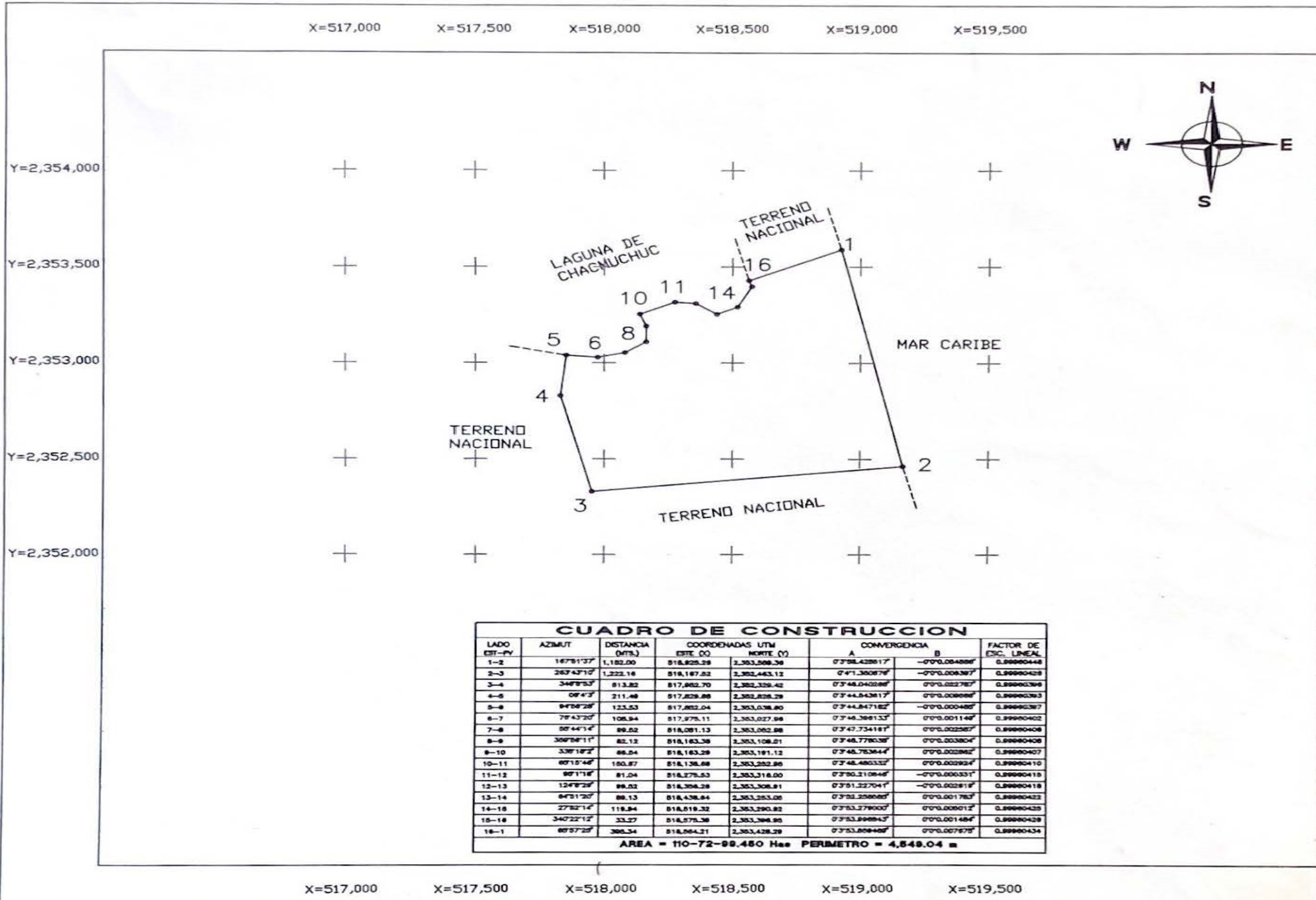

PLANO TOPOGRÁFICO

PREDIO: "LA ABUNDANCIA".

MUNICIPIO: ISLA MUJERES

ESTADO: QUINTANA ROO

POSESIONARIO:

SUPERFICIE: 110-72-99.45 ha

CON UN RANGO DE +/- 0.5% PARA EL ÁREA.

ESCALA 1: 25.47

DATUM WGS 84

ZONA UTM 16

CUADRO DE CONSTRUCCION								
LADO EST-PT	AZIMUT	DISTANCIA (Mts.)	COORDENADAS UTM		CONVERGENCIA		FACTOR DE ESC. LINEAL	
			ESTE (X)	NORTE (Y)	A	B		
1-2	167°13'37"	1,182.00	518,825.29	2,353,266.36	0'3'58.428617"	-0'0'0.064886"	0.99990448	
2-3	263°43'10"	1,222.16	518,167.52	2,352,463.12	0'4'1.360879"	-0'0'0.008397"	0.99990428	
3-4	346°5'53"	813.82	517,802.70	2,352,329.42	0'3'48.040289"	0'0'0.022787"	0.99990398	
4-5	09°4'3"	211.46	517,829.86	2,352,828.29	0'3'44.843617"	0'0'0.008986"	0.99990363	
5-6	84°58'28"	123.53	517,802.04	2,353,038.80	0'3'44.847182"	-0'0'0.000480"	0.99990387	
6-7	78°43'20"	108.84	517,975.11	2,353,027.88	0'3'46.369133"	0'0'0.001146"	0.99990402	
7-8	00°44'14"	86.52	518,081.13	2,353,052.88	0'3'47.734181"	0'0'0.002587"	0.99990408	
8-9	306°56'11"	82.12	518,183.38	2,353,108.01	0'3'48.778038"	0'0'0.003804"	0.99990408	
9-10	336°18'22"	86.54	518,183.29	2,353,191.12	0'3'48.763644"	0'0'0.002862"	0.99990407	
10-11	60°15'46"	150.87	518,136.88	2,353,252.86	0'3'48.480332"	0'0'0.002924"	0.99990410	
11-12	60°11'16"	81.04	518,275.53	2,353,318.00	0'3'50.210846"	-0'0'0.000331"	0.99990418	
12-13	124°8'29"	86.02	518,356.28	2,353,308.81	0'3'51.227041"	-0'0'0.002918"	0.99990418	
13-14	84°31'20"	88.13	518,438.84	2,353,283.08	0'3'52.258680"	0'0'0.001783"	0.99990422	
14-15	27°52'14"	118.84	518,519.32	2,353,290.82	0'3'53.279000"	0'0'0.000012"	0.99990425	
15-16	340°22'12"	33.27	518,575.38	2,353,286.85	0'3'53.898843"	0'0'0.001484"	0.99990428	
16-1	60°37'29"	380.34	518,864.21	2,353,428.29	0'3'53.858480"	0'0'0.007675"	0.99990434	

AREA = 110-72-99.460 Hec PERIMETRO = 4,548.04 m

# LA ABUNDANCIA HOTEL LAND



# LA ABUNDANCIA HOTEL LAND

## **The current situation of the world hotel industry**

**The post-COVID-19 pandemic is surprisingly having a positive effect on the global hotel industry; as never seen before, people around the world are traveling a lot throughout this year and booking for 2023, this circumstance has contributed to reaching levels of hotel occupancy never seen before. This fact makes the International investors in the hotel sector to know that currently Mexico, after France, is already the second nation attracting tourists worldwide, a fact that means a guarantee of success for any investor with a modern hotel vision project that contemplates well-managed, and well-operated hotels, with powerful tour operators that include within their commercial objectives and targets a balance between modernity and respect for ecology and care for the environment.**



# LA ABUNDANCIA HOTEL LAND WITH THE BEST BEACHES IN THE WORLD

