

## SUPERFICIE POR DEPARTAMENTO

NIVELES	DEPTO. No.	UNIDAD	SALA, COCINA Y COMEDOR	RECAMARA 1	RECAMARA 2	PATIO DE SERVICIO	BAÑO	BALCON	PATIO JARDIN	COCHERA	M2 CONSTRUCCION	COSTO X DPTO
PLANTA BAJA	1	m <sup>2</sup>	24.63	11.19		4.05	3.21				43.08	\$ 975,000.00
	2	m <sup>2</sup>	37.16	10.21	10.26	4.22	9.18		14.76	15.19	71.03	\$ 1,725,000.00
	3	m <sup>2</sup>	37.16	10.21	10.26	4.22	9.18		14.76	13.97	71.03	\$ 1,640,000.00
	4	m <sup>2</sup>	24.63	11.19		4.05	3.21				43.08	\$ 975,000.00
1ER NIVEL	5	m <sup>2</sup>	37.16	9.99	10.26	4.22	8.91	6.99		15.19	77.53	\$ 1,680,000.00
	6	m <sup>2</sup>	37.16	10.21	10.26	4.22	9.18				71.03	\$ 1,525,000.00
	7	m <sup>2</sup>	37.16	10.21	10.26	4.22	9.18				71.03	\$ 1,525,000.00
	8	m <sup>2</sup>	37.16	9.99	10.26	4.22	8.91	6.99		13.97	77.53	\$ 1,680,000.00
2DO. NIVEL	9	m <sup>2</sup>	37.16	9.99	10.26	4.22	8.91	6.99			77.53	\$ 1,715,000.00
	10	m <sup>2</sup>	37.16	10.21	10.26	4.22	9.18				71.03	\$ 1,630,000.00
	11	m <sup>2</sup>	37.16	10.21	10.26	4.22	9.18				71.03	\$ 1,630,000.00
	12	m <sup>2</sup>	37.16	9.99	10.26	4.22	8.91	6.99			77.53	\$ 1,630,000.00

**TOTAL 822.46 \$ 18,330,000.00**

   VENDIDO  
   APARTADO

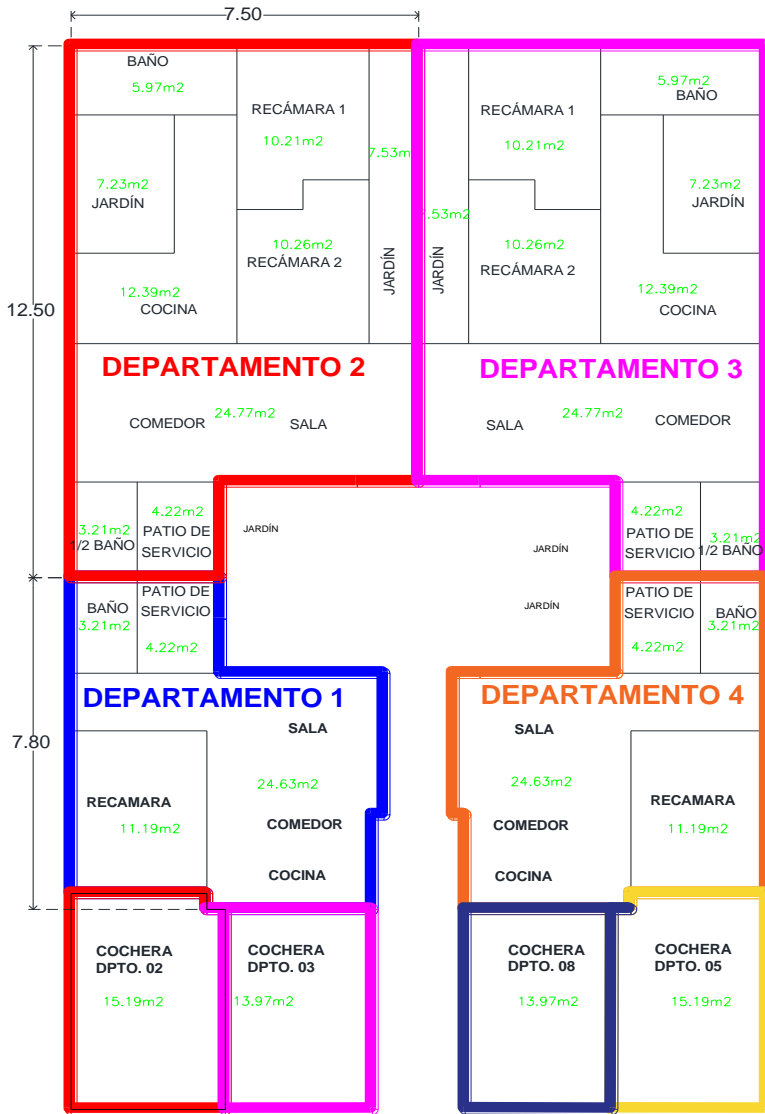

**PLANTA BAJA**



**1RO. Y 2DO. NIVEL**