



UBICACIÓN:



ESCALA: 1:250
FECHA: MARZO 2024

NOTAS:
ELABORACIÓN PROPIA A PARTIR DE LEVANTAMIENTO TOPOGRAFICO.

LAS COTAS ESTAN REPRESENTADAS EN METROS
SIMBOLOGIA:

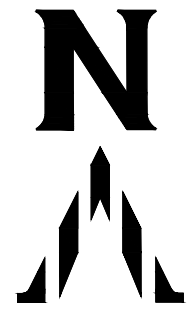
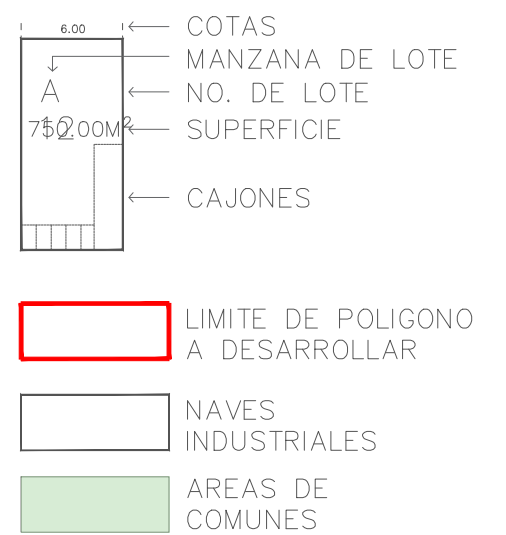

Aeropuerto III	
Superficie Total	33,827.76 m ²
Superficie Vendible	23,620.55 m ²
ACD	2,706.22 m ²
Aprovechamiento	70.00 %

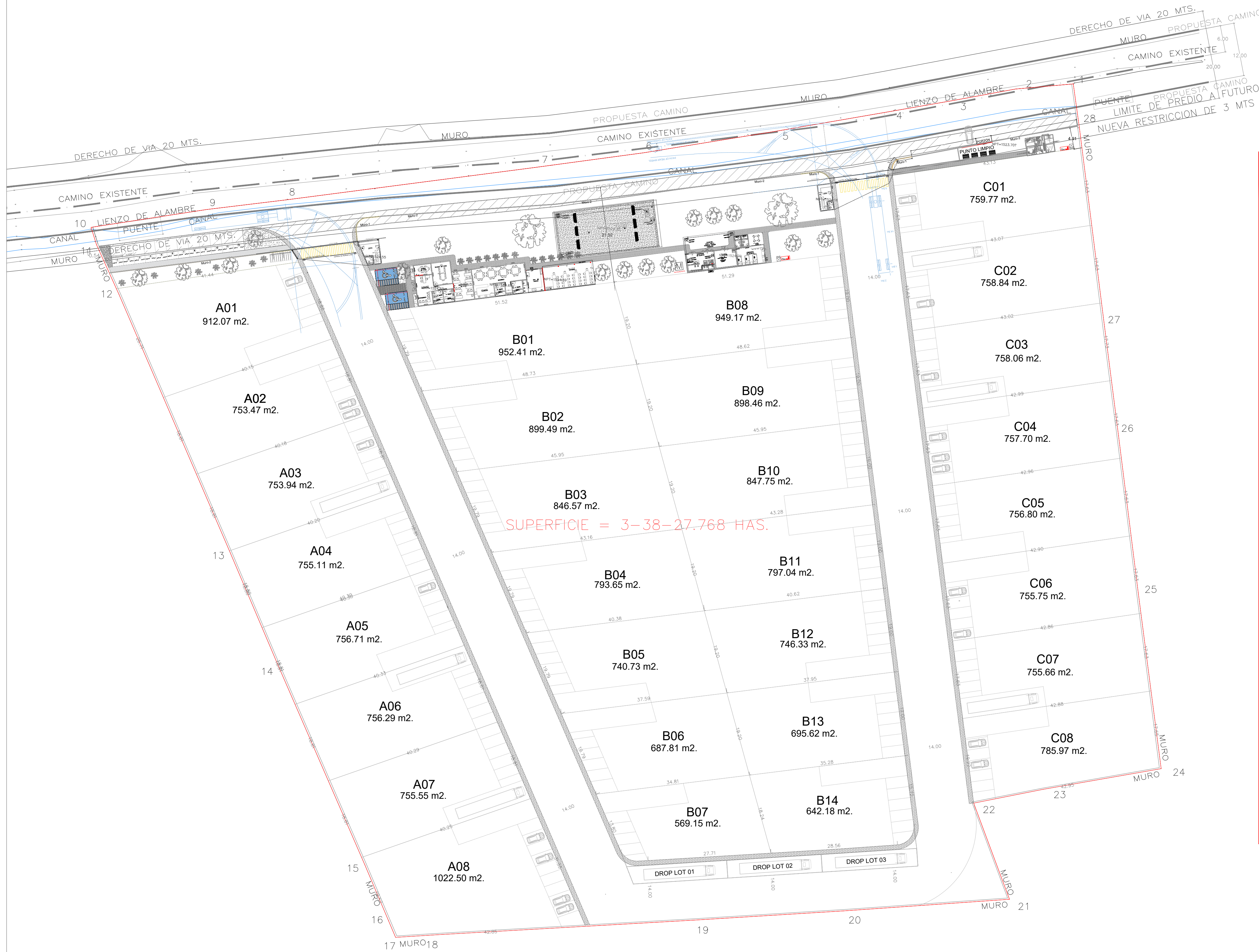

CUADRO DE CONSTRUCCION							
LADO	EST	PV	RUMBO	DISTANCIA	V	COORDENADAS	
						Y	X
					1	2,268,652.1730	680,263.0033
1		2	S 84°55'19.30" W	13.083	2	2,268,651.0150	680,249.9720
2		3	S 79°37'14.57" W	13.837	3	2,268,648.5220	680,236.3610
3		4	S 80°03'43.67" W	14.202	4	2,268,646.0710	680,222.3720
4		5	S 80°12'14.65" W	26.202	5	2,268,641.6130	680,196.5520
5		6	S 80°42'19.98" W	30.636	6	2,268,636.6650	680,166.3180
6		7	S 82°20'33.43" W	24.683	7	2,268,633.3760	680,141.8550
7		8	S 82°34'32.46" W	56.440	8	2,268,626.0830	680,085.8880
8		9	S 83°04'01.33" W	18.317	9	2,268,623.8720	680,067.7050
9		10	S 81°12'55.28" W	26.297	10	2,268,619.8558	680,041.7160
10		11	S 17°31'34.62" E	4.107	11	2,268,615.9395	680,042.9528
11		12	S 24°21'06.78" E	12.225	12	2,268,604.8026	680,047.9935
12		13	S 23°17'14.14" E	63.460	13	2,268,546.5124	680,073.0818
13		14	S 23°02'55.17" E	27.597	14	2,268,521.1181	680,083.8865
14		15	S 23°29'04.74" E	48.969	15	2,268,476.2050	680,103.4010
15		16	S 22°59'07.98" E	13.630	16	2,268,463.6575	680,108.7234
16		17	S 22°59'07.98" E	4.119	17	2,268,459.8658	680,110.3318
17		18	N 86°21'32.52" E	8.862	18	2,268,460.4285	680,119.1760
18		19	N 86°45'12.05" E	58.833	19	2,268,463.7605	680,177.9148
19		20	N 86°26'56.91" E	33.392	20	2,268,465.8286	680,211.2428
20		21	N 85°59'36.82" E	37.472	21	2,268,468.4468	680,248.6232
21		22	N 20°25'54.08" W	23.128	22	2,268,490.1201	680,240.5493
22		23	N 78°49'20.10" E	15.966	23	2,268,493.2151	680,256.2120
23		24	N 80°03'20.09" E	26.985	24	2,268,497.8752	680,282.7916
24		25	N 07°25'19.80" W	39.841	25	2,268,537.3820	680,277.6450
25		26	N 07°09'48.56" W	35.838	26	2,268,572.9401	680,273.1760
26		27	N 07°18'44.85" W	24.795	27	2,268,597.5337	680,270.0200
27		28	N 07°11'38.87" W	45.142	28	2,268,642.3205	680,264.3668
28		1	N 07°52'44.54" W	9.946	1	2,268,652.1730	680,263.0033
SUPERFICIE = 33,827.768 m ²							

PROYECTO:
NAVES INDUSTRIALES AEROPUERTO III

LAMINA:
LAMINA/UNICA ESTADO PROPUESTO

ELABORO:
ARQ. D. M.
ARQ. M. P.
PROPIETARIO:

