

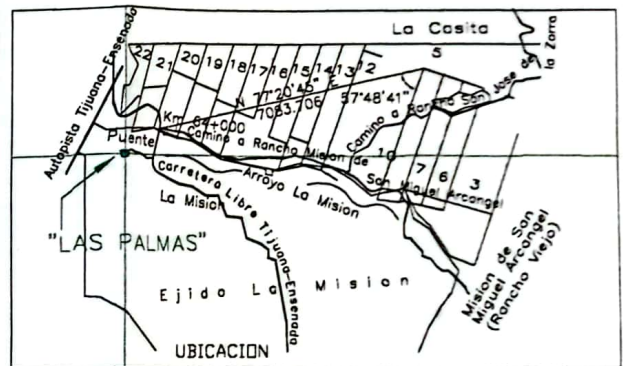

CUADRO DE CONSTRUCCION							
LADO	EST	PV	RUMBO	DISTANCIA	V	COORDENADAS	
						Y	X
					1	3,550,789.8402	512,204.7189
1	2		S 27°15'45" E	120.89	2	3,550,682.3806	512,260.0940
2	3		S 82°03'43" E	39.50	3	3,550,676.9250	512,299.2197
3	4		N 59°08'28" E	93.75	4	3,550,725.0130	512,379.6995
4	5		N 06°08'57" E	98.48	5	3,550,822.9310	512,390.2487
5	6		N 05°54'00" W	27.73	6	3,550,850.5147	512,387.3983
6	7		S 71°11'42" W	17.43	7	3,550,844.8959	512,370.8980
7	8		S 55°49'30" W	12.37	8	3,550,837.9485	512,360.6656
8	9		S 68°53'57" W	63.71	9	3,550,815.0125	512,301.2276
9	10		S 81°44'50" W	69.65	10	3,550,805.0154	512,232.3035
10	1		S 61°11'00" W	31.48	1	3,550,789.8402	512,204.7189

SUPERFICIE = 20,000.0000 m²

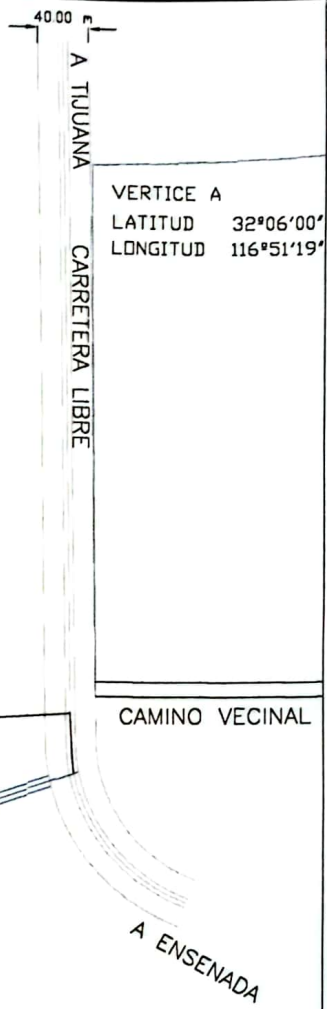
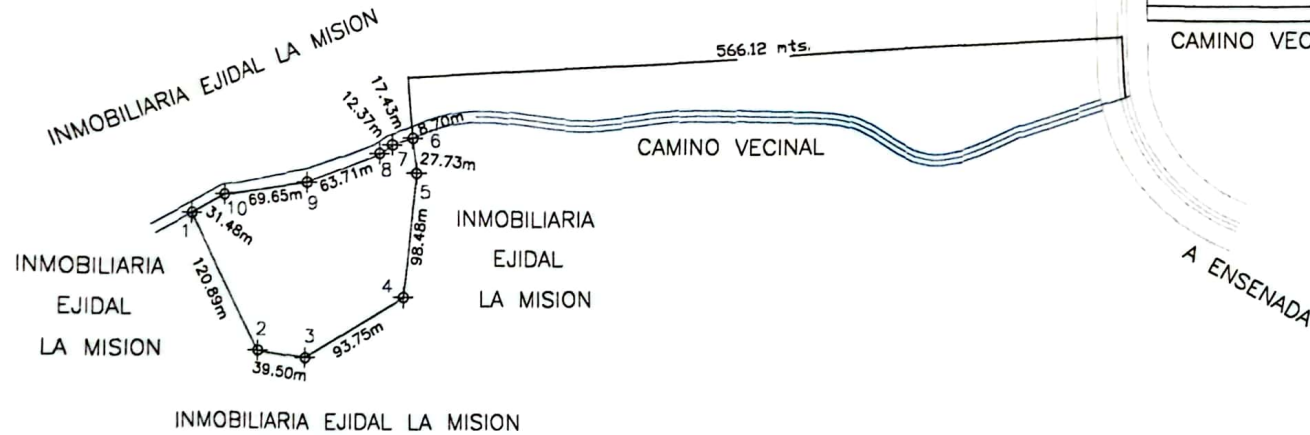

PERITO:

ING. ALEJANDRO ESPINOZA GLEZ.
 CED. PRF. 6090507
 CED. EST. 5830/92

PLANO DEL PREDIO CONOCIDO COMO "LAS PALMAS"
 UBICADO EN LA DELEGACION DE LA MISION, MUNICIPIO DE ENSENADA, BAJA CALIFORNIA

POSESIONARIOS: _____ CLAVE CATASTRAL: _____

SUPERFICIE DE DOCUMENTOS: 2-00-00.00 HAS. ESCALA: 1: 4,000

FECHA: AGOSTO DE 2002