



TORRE  
**PIETRA**

P R E V E N T A





# S O N O M A

Lujoso complejo residencial rodeado de naturaleza y áreas verdes que hacen de Sonoma una comunidad única en la Ciudad de Monterrey. Cuenta con arroyos, jardines y más de 2,000 árboles de diferentes especies que brindan armonía y tranquilidad en un ambiente completamente sustentable fortaleciendo la salud y el bienestar de los residentes.

# CLUB SONOMA







**FAMILY EVENTS**



**COMMUNITY EVENTS**

A young boy is sliding down a water slide. He is sitting on a blue inflatable ring with white and blue patterns. He is wearing blue flip-flops and has a joyful expression with his mouth open. The slide is orange and curved. Water is splashing around the bottom of the ring.

**WATER PARK**

A young girl is playing soccer on a green artificial turf field. She is wearing a blue soccer jersey with "KON" on the front, black shorts, and blue socks. She is running towards the camera, kicking a black and red soccer ball. In the background, there are wooden bleachers and a goalpost.

**SOCCER FIELD**

A man and a woman are jogging on a track. The man is wearing a brown jacket and the woman is wearing a light-colored long-sleeved top. They are running towards the camera. The background is a bright, sunny outdoor setting with trees and a building.

**JOGGING TRACK**



## HOSTING WORLD-CLASS EVENTS

Club Sonoma es sede del Torneo Internacional de Tenis Abierto Monterrey WTA Tour y ATP (Champions Tour y Challenger Tour). En estos eventos participan jugadores de talla internacional que brindan un gran espectáculo de tenis de primer nivel.



**DRIVING RANGE**

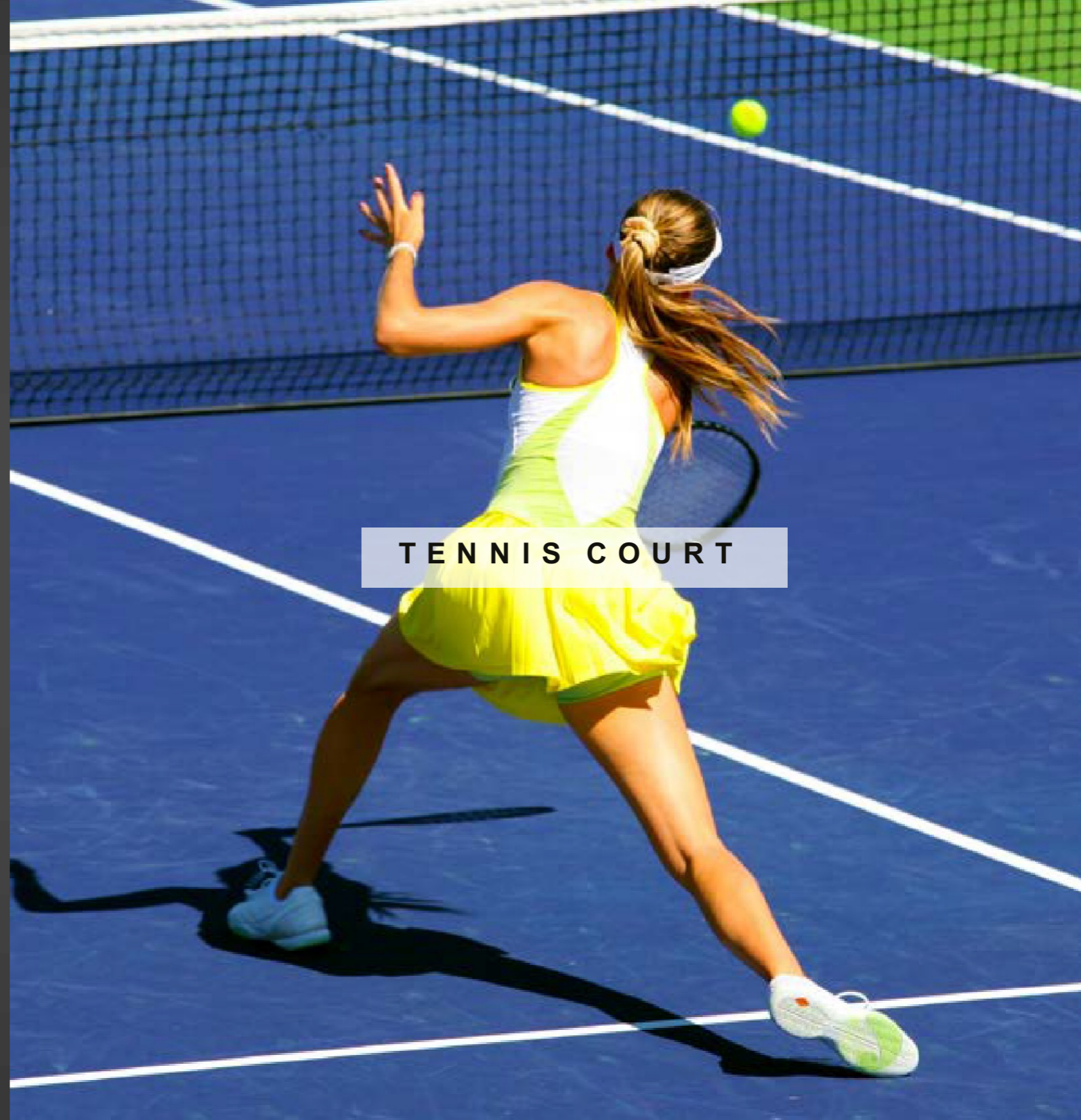

**TENNIS COURT**



**RESTAURANT**



**VENTO | SOLD OUT**



**FORESTA | SOLD OUT**



**ALBERI | SOLD OUT**





TORRE  
**PIETRA**





NEW TOWER  
NEW AMENITIES





CREATING  
COMMUNITY  
IN NATURE

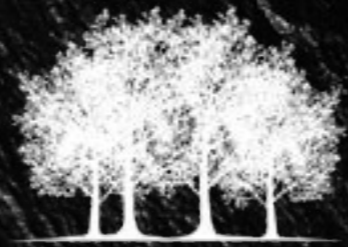

**THE CLUB COMPANY**

- MASTER LAND DEVELOPERS -



**PAGA**  
DESARROLLOS

GVI

GOMEZ VAZQUEZ  
INTERNATIONAL



*ONE OF LATIN  
AMERICA'S LEADING  
ARCHITECTURAL FIRMS*

GVI hoy es una de las mejores firmas de arquitectura a nivel Latinoamérica, logrando el equilibrio entre innovación y destreza.

GVI ha completado más de 1,000 proyectos en más de 81 destinos alrededor del mundo, demostrando el compromiso con la excelencia en el diseño, la innovación y la sustentabilidad.



## DISEÑO SUSTENTABLE Y VANGUARDISTA

Torre PIETRA permite crear valor económico, social y ambiental en beneficio de los residentes, mejorando su calidad de vida y la de su comunidad.

PIETRA contará con departamentos desde 125 m<sup>2</sup> hasta 356 m<sup>2</sup> aproximadamente, ofreciendo opciones que se adapten específicamente a todas las necesidades.

\*IMÁGEN DE REFERENCIA

2

# AMENITY FLOORS

---

A PLACE TO CREATE A LIFETIME OF MEMORIES



# LOBBY

GAME ROOM | BEATY SPA & BARBER SHOP | WELLNESS CENTER



A modern game room with a pool table, a carrom board, and a lounge area. The room features large windows with a view of a garden, several large woven pendant lights, and two televisions mounted on the wall. The furniture includes a grey sofa, a white rug, and a dining table with chairs.

## GAME ROOM



# BEAUTY SPA





# BARBER SHOP



WELLNESS CENTER



# THE ROOFTOP

LIVING ROOM | SPORT BAR | SKY LOUNGE *MONTAIN VIEW* | SKY BAR *CITY VIEW* | BUSINESS CENTER



LIVING ROOM

\*IMAGEN DE REFERENCIA

# SPORTS BAR



SKY LOUNGE | MOUNTAIN VIEW







SKY BAR | CITY VIEW

A modern, high-rise business center lounge. The room features a large wall of built-in white bookshelves filled with books, a central fireplace, and a television mounted on the wall. The seating area includes several brown leather armchairs and a dark grey sofa, arranged around a dark wood coffee table. Large floor-to-ceiling windows on the right side offer a panoramic view of a city skyline under a blue sky. In the background, a desk with two laptops and office chairs is visible. The floor is covered with a dark, patterned carpet. The overall atmosphere is professional and sophisticated.

BUSINESS CENTER

# RESIDENCES



# RESIDENCE A2



NOTA:  
ESTE DEPARTAMENTO SE ENCUENTRA  
EN EL MISMO NIVEL QUE ESTACIONAMIENTO

## PROGRAMA

- 1 SALA-COMEDOR
- 2 COCINA
- 3 UTILITY
- 4 BAÑO
- 5 RECAMARA PRINCIPAL
- 6 BAÑO
- 7 VESTIDOR
- 8 RECAMARA 2

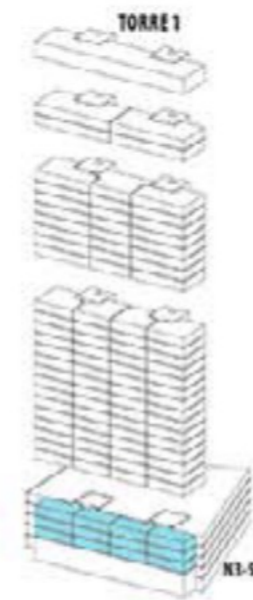

## SUPERFICIE

DEPARTAMENTO 98.75M2  
TERRAZA 26.67M2  
TOTAL 125.42M2

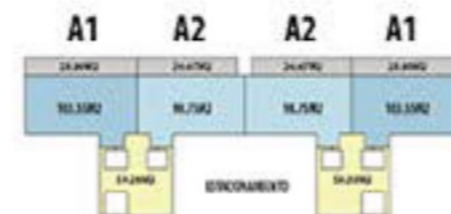

# RESIDENCE B2



NOTA:  
EN EL NIVEL 6 TIENE UN PATIO

NOTA:  
EL DEPARTAMENTO CON LA MISMA TIPOLOGIA QUE APARECE EN EL NIVEL TIPO, ES SIMETRICO A ESTA PLANTA

## PROGRAMA

- 1 SALA-COMEDOR
- 2 COCINA
- 3 UTILITY
- 4 RECAMARA DE SERVICIO
- 5 BAÑO SERVICIO
- 6 1/2 BAÑO
- 7 CLOSET
- 8 RECAMARA PRINCIPAL
- 9 BAÑO
- 10 VESTIDOR
- 11 RECAMARA 2
- 12 BAÑO
- 13 VESTIDOR
- 14 RECAMARA 3
- 15 BAÑO
- 16 VESTIDOR

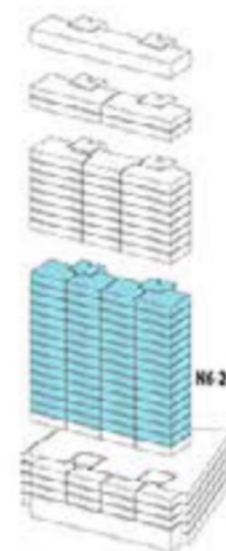

## SUPERFICIE

DEPARTAMENTO	145.55M2
TERRAZA	25.67M2
TOTAL	171.22M2

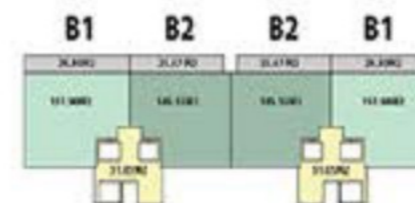



P A Y M E N T

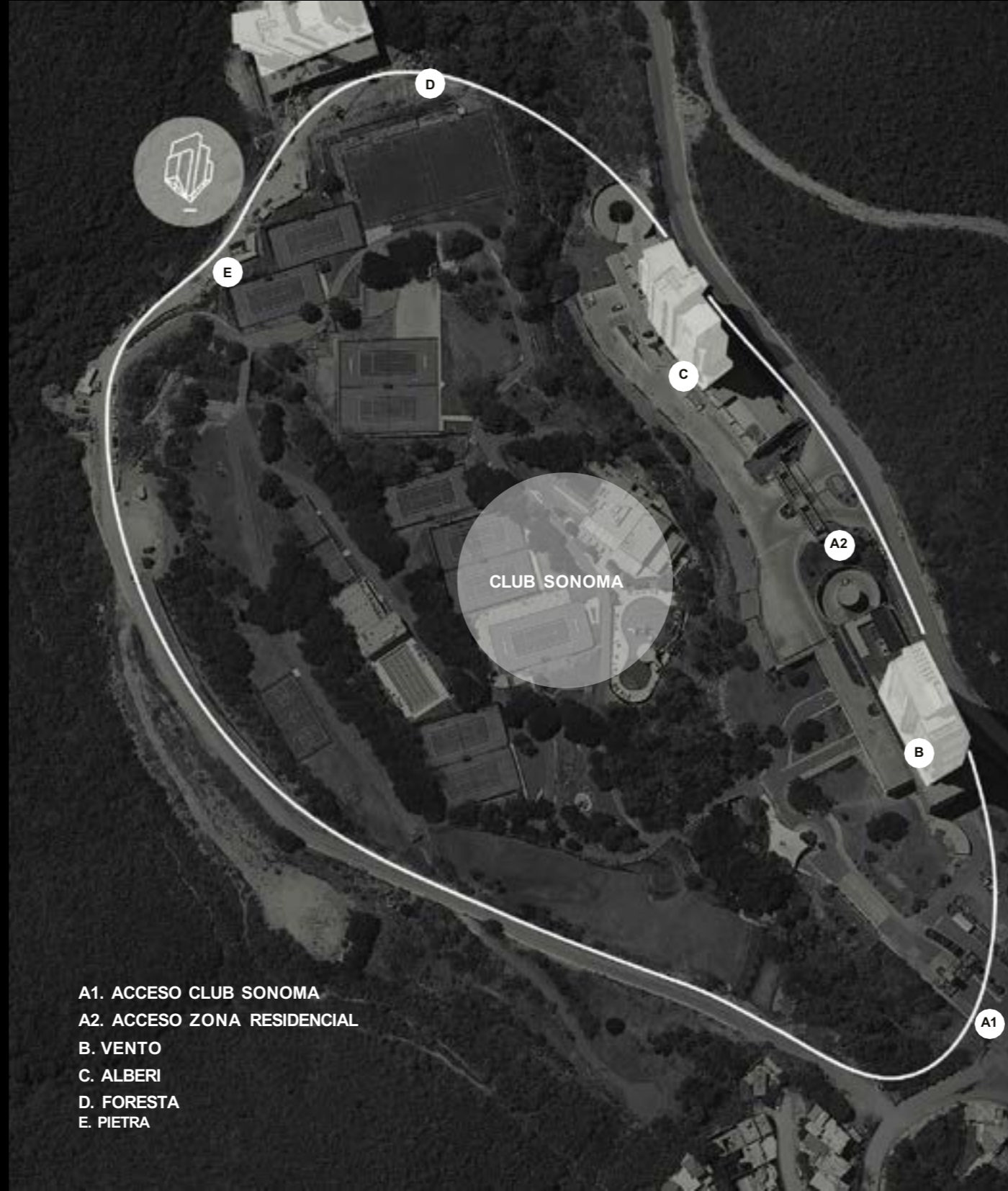

- A1. ACCESO CLUB SONOMA
- A2. ACCESO ZONA RESIDENCIAL
- B. VENTO
- C. ALBERI
- D. FORESTA
- E. PIETRA

THE PLACE TO LIVE

---





# VENTA

## DEPARTAMENTO NO. 503

**METROS:** 185 M2  
**PRECIO:** \$9,500,000.00 MX

## DEPARTAMENTO NO. 101

**METROS:** 132 M2  
**PRECIO:** \$7,000,000.00 MX

- \*\*\* ACCIÓN GRATIS CLUB SONOMA \$500,000
- \*\*\* ENTREGA EN OBRA GRIS
- \*\*\* LISTA DE ESPERA DE ARRENDATORIOS



TORRE

# PIETRA



TORRE  
**PIETRA**

THANK YOU

