



NAVÍO

PUERTO SERENO
AT CAP CANA

(+1) 809 669 3958 - (+1) 829 471 5568

www.naviodr.com

[@naviopuertosereno](https://www.instagram.com/naviopuertosereno)

info@naviodr.com

Discover the infinity of
pleasures that we offer you.

Descubre la infinidad
de placeres que tenemos para ofrecerte

Preliminary views, subject to changes.
Vistas preliminares (Conceptuales) Sujetas a cambios

NAVÍO PUERTO SERENO
AT CAP CANA

Urban elegance on the shores
of the Caribbean sea

Elegancia urbana
a orillas del mar Caribe

Preliminary views, subject to changes.
Vistas preliminares (Conceptuales) Sujetas a cambios



Navío Puerto Sereno at Cap Cana is located in the spectacular Cap Cana Marina, in Punta Cana. The ideal destination for those who want to enjoy a quiet and safe lifestyle.

Navío Puerto Sereno en Cap Cana se encuentra en la espectacular Marina de Cap Cana, en Punta Cana. El destino ideal para aquellos que quieran disfrutar de un ambiente tranquilo y estilo de vida seguro.

Preliminary views, subject to changes.
Vistas preliminares (Conceptuales) Sujetas a cambios

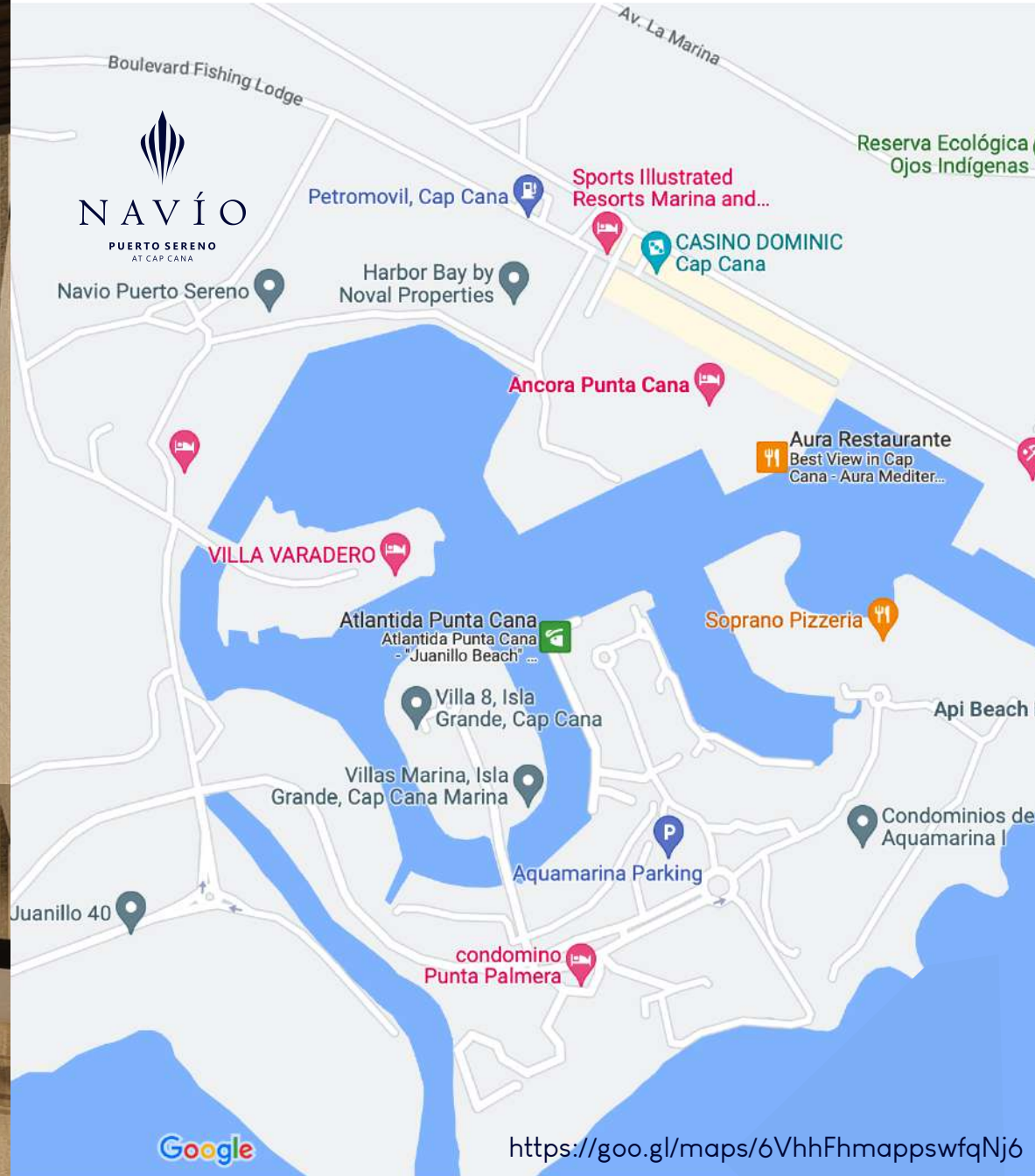

Location

Ubicación



Preliminary views, subject to changes.
Vistas preliminares (Conceptuales) Sujetas a cambios



CAPCANANA
REPÚBLICA DOMINICANA

Ciudad Destino

Golf at Cap Cana

Golf en Cap Cana

**Nowhere else in the world
will the golf experience be like this...**

Punta Espada is one of the Nicklaus Signature golf courses. It is listed among the world's finest, with the renowned GolfWeek publication ranking it as the "#1 Best Golf Course in the Caribbean and Mexico". From all points of Punta Espada, golfers are blessed with extraordinary views of the Caribbean.

**En ningún otro lugar del mundo
será así la experiencia del golf...**

Punta Espada diseñado por Jack Nicklaus, esta listado entre los mejores del mundo, la revista GolfWeek lo clasifica como el "#1 mejor campo de golf en el Caribe y México". Desde todos los puntos del campo, los golfistas son bendecidos con extraordinarias vistas al Caribe.



CAP CANA
REPÚBLICA DOMINICANA

Ciudad Destino

1. OFICINA DE INFORMACIÓN Y VENTAS
INFORMATION AND SALES CENTER
2. HERITAGE SCHOOL
3. ANCOR A CAP CANA
4. TRS PALLADIUM HOTEL
5. MARINA CAP CANA
6. SECRET CAP CANA
7. HYATT ZIVA & HYATT ZILARA
8. MARGARITAVILLE ISLAND RESERVE
9. SANCTUARY CAP CANA
10. ST. REGIS RESORT & RESIDENCES CAP CANA
11. PUNTA ESPADA GOLF COURSE
12. HOTEL EDEN ROC CAP CANA BEACH CLUB
13. EDEN ROC CAP CANA BEACH CLUB
14. LOS ESTABLOS





ZONA RESIDENCIAL

- | | | |
|--------------------------|---------------------------------|--|
| 1. CIUDAD LAS CANAS | 12. GREEN VILLAGE | 22. AQUAMARINA |
| 2. FARALLON ESTATES | 13. GOLDEN BEAR LOGDE | 23. OCEÁN 21 |
| 3. LAS LAGUNAS | 14. LAS IGUANAS HOMESITES | 24. ISLA GRANDE |
| 4. LOS ESTABLOS | 15. LAS IGUANAS GOLF RESIDENCES | 25. FUNDADORES |
| 5. FARALLON PUNTA ESPADA | 16. FAIRWAY HOMESITES | 26. FISHING LOGDE |
| 6. CALETON ESTATES | 17. THE LEGENDS | 27. ISLA DEL PUERTO |
| 7. CALETON VILLAS | 18. IL LAGO | 28. RACQUET VILLAGE |
| 8. YARARI | 19. LAGOON ESTATES | 29. PUNTA MARAVILLA |
| 9. LAS PALMAS | 20. JUANILLO BAY | 30. VILLAS MARINA |
| 10. PUNTA MAJAGUA | 21. PUNTA PALMERA | 31. NAVÍO <small>PUERTO SERENO
AT CAP CANA</small> |





SCAPE PARK
AT CAP CANA





CAPCANA
REPÚBLICA DOMINICANA

Ciudad Destino



An architectural rendering of a modern villa at dusk. The scene features a large, rectangular swimming pool with a glowing blue light effect. Two tall palm trees stand prominently in the foreground. To the left, a covered outdoor lounge area with a bar and seating is visible. In the background, the ocean is visible with a sunset or sunrise over the horizon, and a white yacht is docked on the right. The sky is dark with some clouds.

NAVÍO PUERTO SERENO
AT CAP CANA

Lounge by the pool or on the beach,
play golf or tennis, go fishing,
visit the stables, or just relax at
Navío Puerto Sereno.

Descansa junto a la piscina o en la playa,
jugar al golf o al tenis, ir de pesca,
visite los establos, o simplemente relájese en
Navío Puerto Sereno.

Preliminary views, subject to changes.
Vistas preliminares (Conceptuales) Sujetas a cambios

NAVÍO PUERTO SERENO
AT CAP CANA

With a modern, refined, and elegant design, Navío Puerto Sereno at Cap Cana proposes importing the luxury of a boutique hotel to the intimacy of a private residence.

Con un diseño moderno, refinado y elegante, Navío Puerto Sereno en Cap Cana propone importar el lujo de un hotel boutique a la intimidad de una residencia privada.

Conceptual rendering, subject to changes.
Vistas preliminares (Conceptuales). Sujetas a cambios.





70 apartments with 1, 2 and 3 bedrooms distinguished by construction with the highest quality standards and using excellent materials, guaranteeing the experience of a comfortable and safe stay within the largest and most exclusive Marina in the Caribbean.

70 apartamentos de 1, 2 y 3 dormitorios construidos con los más altos estándares de calidad y utilizando excelentes materiales, garantizan una experiencia cómoda y segura dentro de la más grande y exclusiva Marina en el Caribe.

Preliminary views, subject to changes.
Vistas preliminares (Conceptuales) Sujetas a cambios

NAVÍO PUERTO SERENO
AT CAP CANA

Amenities

Amenidades



Children's area
Área infantil



BBQ area
Área de BBQ



Gym
Gimnasio



Parking for visitors
Estacionamiento
para visitantes



4 elevators
(12 people capacity)
4 ascensores
(capacidad para 12 personas)



Double height lobby
Lobby de doble altura



Infinity pool
Piscina infinita



Children's pool
Piscina infantil

Preliminary views, subject to changes.
Vistas preliminares (Conceptuales) Sujetas a cambios

Nearby

Punta Cana International Airport (10 mins away)
Fishing Lodge Cap Cana (1 min away)
Marina Cap Cana (3 mins away)
Lago Azul Cap Cana (4 mins away)
Playa Juanillo Cap Cana (5 mins away)
Api Beach & Restaurant (5 mins away)
Punta Espada Golf Club (10 mins away)

Cercanías

Aeropuerto Internacional Punta Cana (10 mins de distancia)
Fishing Lodge Cap Cana (1 min de distancia)
Marina Cap Cana (3 mins de distancia)
Lago Azul Cap Cana (4 mins de distancia)
Playa Juanillo Cap Cana (5 mins de distancia)
Api Beach & Restaurant (5 mins de distancia)
Punta Espada Golf Club (10 mins de distancia)

Preliminary views, subject to changes.
Vistas preliminares (Conceptuales) Sujetas a cambios

NAVÍO PUERTO SERENO
AT CAP CANA

1 Habitación.....20 apartamentos
1 Habitación(penthouse).....4 apartamentos
2 Habitaciones.....28 apartamentos
2 Habitaciones (penthouse)....6 apartamentos
3 Habitaciones.....10 apartamentos
3 Habitaciones (penthouse)....2 apartamentos

1 Bedrooms.....20 apartments
1 Bedrooms (penthouse).....4 apartments
2 Bedrooms.....28 apartments
2 Bedrooms (penthouse).....6 apartments
3 Bedrooms.....10 apartments
3 Bedrooms (penthouse).....2 apartments

Preliminary views, subject to changes.

Vistas preliminares (Conceptuales), Sujetas a cambios



First Floor
Planta Primer Piso

NAVÍO PUERTO SERENO
AT CAP CANA

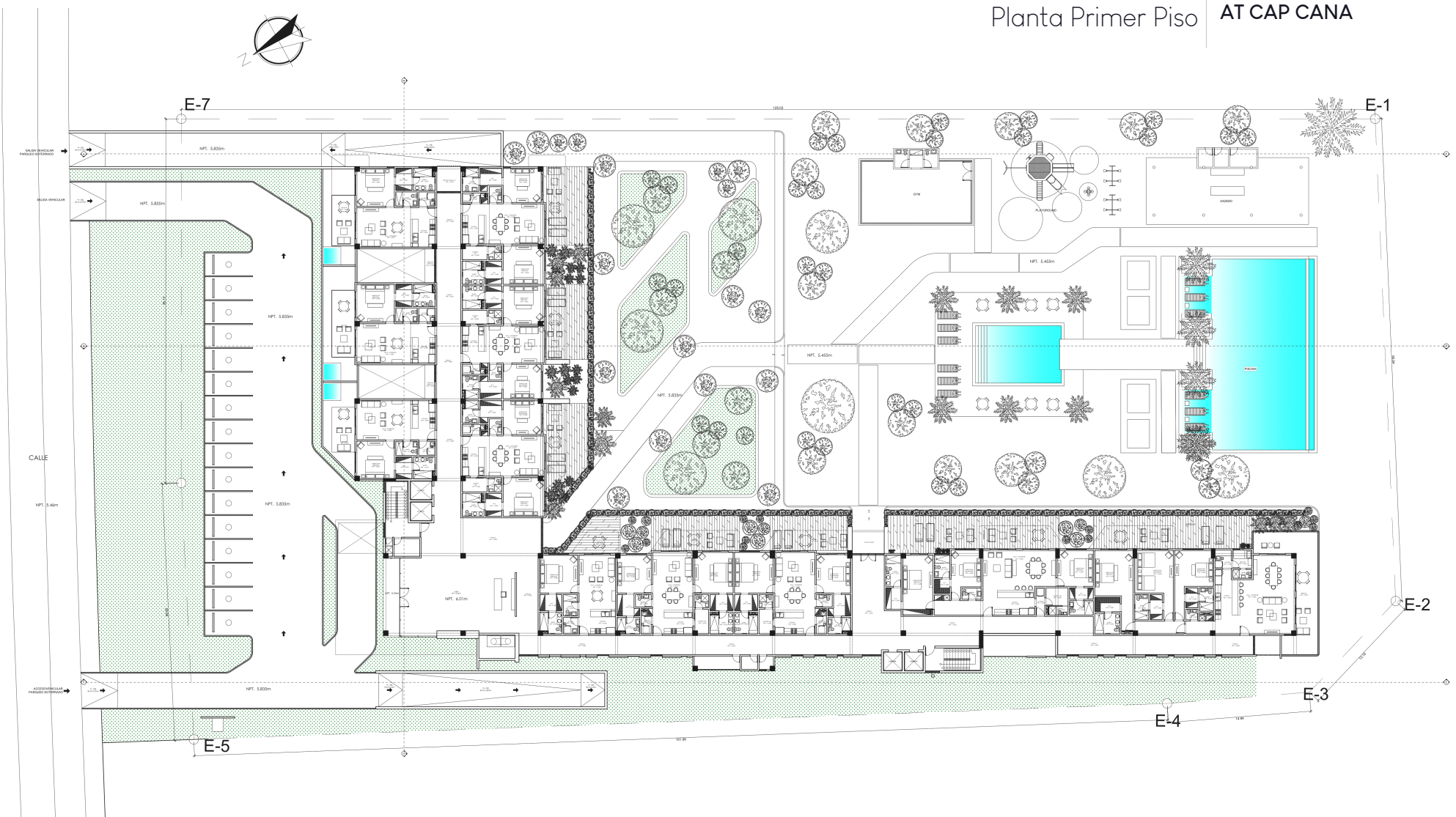

Preliminary views, subject to changes.
Vistas preliminares (Conceptuales) Sujetas a cambios

3 Habitaciones con cuarto útil
3 Bedrooms with service area

NAVÍO PUERTO SERENO
AT CAP CANA



Preliminary views, subject to changes.
Vistas preliminares (Conceptuales) Sujetas a cambios

Tipo K1

Apartamento 3 Habs
+ Área de servicio

262.50 M2

[Apartamento = 191.00 M2]
[Terraza = 71.50 M2]
[1 Unidad]

- 3 Habitaciones
- 3 Vestidores
- Sala comedor
- Cocina
- 4.5 Baños
- Terraza
- Lavado
- Servicio
- 2 Parqueos

Type K1

Apartment 3 Bedrooms
+ service area

262.50 M2

[Apartment = 191.00 M2]
[Terrace = 71.50 M2]
[1 Unit]

- 3 Bedrooms
- 3 Walking closets
- Living room / dining
- Kitchen
- 4.5 Bathroom
- Terraza
- Laundry area
- Service area
- 2 Parking spots

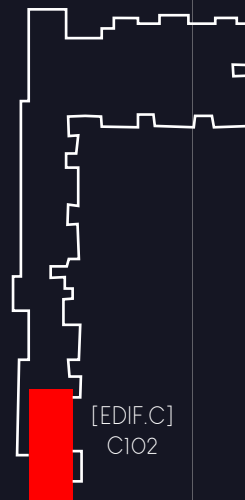

[EDIF.C]
C102



Preliminary views, subject to changes.
Vistas preliminares (Conceptuales) Sujetas a cambios

3 Habitaciones con cuarto útil
3 Bedrooms service area

NAVÍO PUERTO SERENO
AT CAP CANA

ary views, subject to changes.
eliminables (Conceptuales) Sujetas a cambios



Tipo J1

Apartamento 3 Habs
+ Área de servicio

216.50 M2

[Apartamento = 151.50 M2]
[Terraza = 65.00 M2]
[1 Unidad]

- 3 Habitaciones
- 3 Vestidores
- Sala comedor
- Cocina
- 4.5 Baños
- Terraza
- Lavado
- Servicio
- 2 Parqueos

Type J1

Apartment 3 Bedrooms
+ service area

216.50 M2

[Apartment = 151.50 M2]
[Terrace = 65.00 M2]
[1 Unit]

- 3 Bedrooms
- 3 Walking closets
- Living room / dining
- Kitchen
- 4.5 Bathroom
- Terraza
- Laundry area
- Service area
- 2 Parking spots

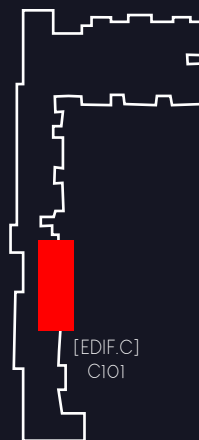

2 Habitaciones
2 Bedrooms

NAVÍO PUERTO SERENO
AT CAP CANA

Preliminary views, subject to changes.
Vistas preliminares (Conceptuales) Sujetas a cambios

Tipo H1

Apartamento 2 Habs

147.5 M2

[Apartamento = 110.00 M2]
[Terraza = 37.50 M2]
[1 Unidad]

- 2 Habitaciones
- 2 Vestidores
- Sala comedor
- Cocina
- 3.5 Baños
- Terraza
- Lavado
- Servicio
- 2 Parquesos

Type H1

Apartment 2 Bedrooms

147.5 M2

[Apartment = 110.00 M2]
[Terrace = 37.50 M2]
[1 Unit]

- 2 Bedrooms
- 2 Walking closets
- Living room / dining
- Kitchen
- 3.5 Bathroom
- Terraza
- Laundry area
- Service area
- 2 Parking spots

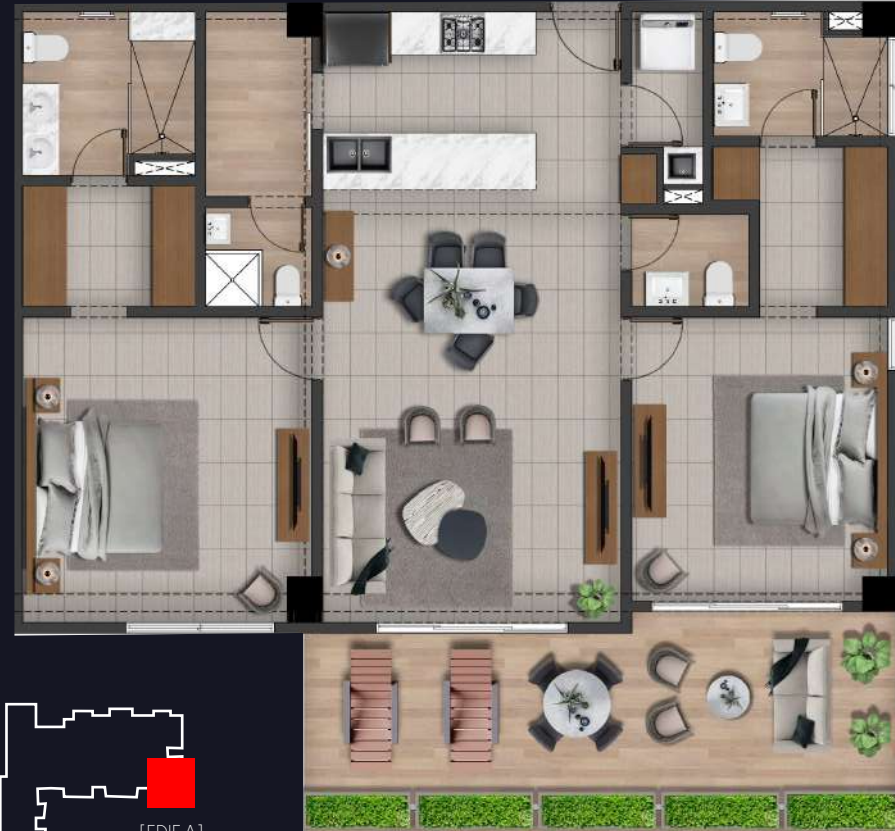

Preliminary views, subject to changes.
Vistas preliminares (Conceptuales) Sujetas a cambios

2 Habitaciones
2 Bedrooms

NAVÍO PUERTO SERENO
AT CAP CANA



Preliminary views, subject to changes.
Vistas preliminares (Conceptuales) Sujetas a cambios

Tipo I1

Apartamento 2 Habs
Edif A & B

143.50 M2

[Apartamento = 110.00 M2]
[Terraza = 33.50 M2]
[4 Unidades]

- 2 Habitaciones
- 2 Vestidores
- Sala comedor
- Cocina
- 3.5 Baños
- Terraza
- Lavado
- Servicio
- 2 Parqueos

Type I1

Apartment 2 Bedrooms
Building A & B

143.50 M2

[Apartment = 110.00 M2]
[Terrace = 33.50 M2]
[4 Units]

- 2 Bedrooms
- 2 Walking closets
- Living room / dining
- Kitchen
- 3.5 Bathroom
- Terraza
- Laundry area
- Service area
- 2 Parking spots

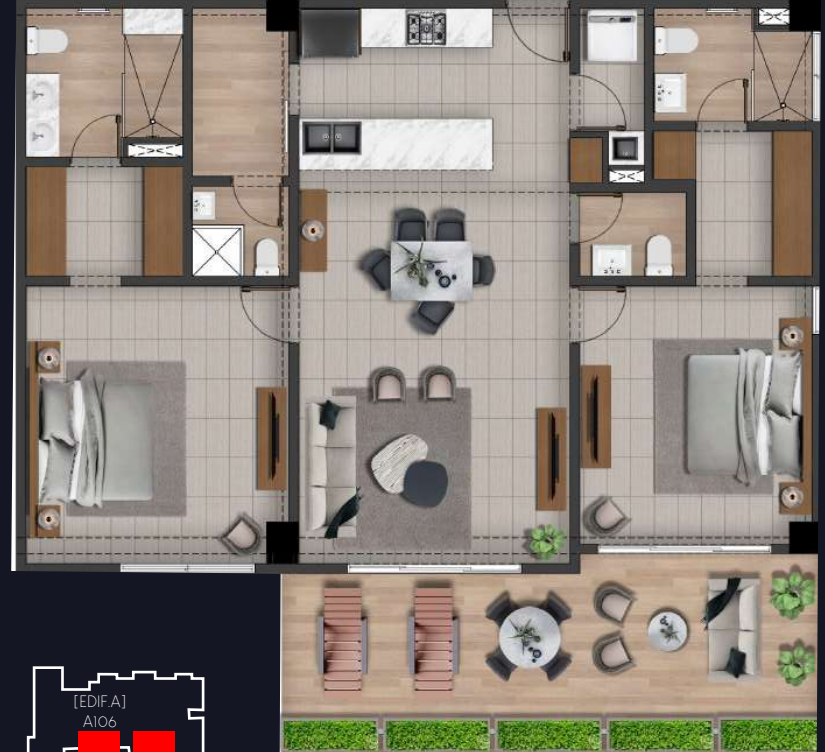

Preliminary views, subject to changes.
Vistas preliminares (Conceptuales) Sujetas a cambios

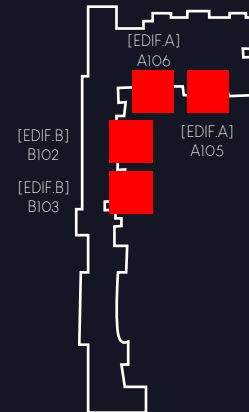

Tipo G1

Apartamento 1 Hab

88.00 M2

[Apartamento = 70.50 M2]
[Terraza = 33.50 M2]
[1 Unidades]

- 1 Habitación
- Vestidor
- Sala comedor
- Cocina
- 2 Baños
- Terraza
- Lavado
- 1 Parqueo

Type G1

Apartment 1 Bedroom

88.00 M2

[Apartment = 70.50 M2]
[Terrace = 65.00 M2]
[1 Units]

- 1 Bedroom
- Walking closet
- Living room / dining
- Kitchen
- 2 Bathroom
- Terraza
- Laundry area
- 1 Parking spot



Tipo A1'

Apartamento 1 Hab

102.50 M2

[Apartamento = 74.00 M2]
[Terraza = 24.50 M2]
[1 Unidad]

- 1 Habitación
- Vestidor
- Sala comedor
- Cocina
- 2 Baños
- Terraza
- Jacuzzi
- Lavado
- 1 Parqueos

Type A1'

Apartment 1 Bedroom

102.50 M2

[Apartment = 74.00 M2]
[Terrace = 24.50 M2]
[1 Unit]

- 1 Bedroom
- Walking closet
- Living room / dining
- Kitchen
- 2 Bathroom
- Terraza
- Jacuzzi
- Laundry area
- 1 Parking spots



NAVÍO PUERTO SERENO
AT CAP CANA

Preliminary views, subject to changes.
Vistas preliminares (Conceptuales) Sujetas a cambios

Tipo A1"

Apartamento 1 Hab

115.50 M2

[Apartamento = 74.00 M2]
[Terraza = 41.00 M2]
[1 Unidad]

- 1 Habitación
- Vestidor
- Sala comedor
- Cocina
- 2 Baños
- Terraza
- Jacuzzi
- Lavado
- 1 Parqueos

Type A1"

Apartment 1 Bedroom

115.50 M2

[Apartment = 74.00 M2]
[Terrace = 41.00 M2]
[1 Unit]

- 1 Bedroom
- Walking closet
- Living room / dining
- Kitchen
- 2 Bathroom
- Terraza
- Jacuzzi
- Laundry area
- 1 Parking spots

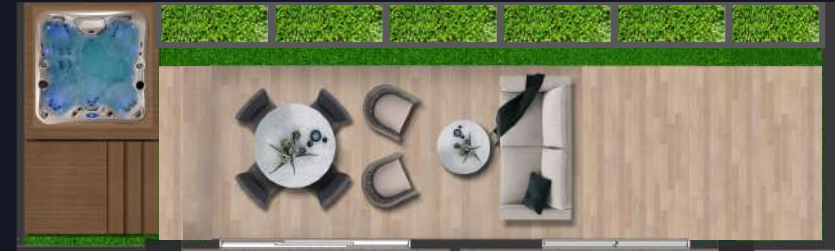

[EDIF.A]
A102

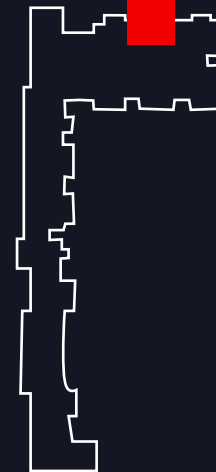

Preliminary views, subject to changes.
Vistas preliminares (Conceptuales) Sujetas a cambios

Tipo A1''

Apartamento 1 Hab

108.00 M2

[Apartamento = 74.00 M2]
[Terraza = 34.00 M2]
[1 Unidad]

- 1 Habitación
- Vestidor
- Sala comedor
- Cocina
- 2 Baños
- Terraza
- Jacuzzi
- Lavado
- 1 Parquesos

Type A1''

Apartment 1 Bedroom

108.00 M2

[Apartment = 74.00 M2]
[Terrace = 34.00 M2]
[1 Unit]

- 1 Bedroom
- Walking closet
- Living room / dining
- Kitchen
- 2 Bathroom
- Terraza
- Jacuzzi
- Laundry area
- 1 Parking spots



[EDIF.A]
A103

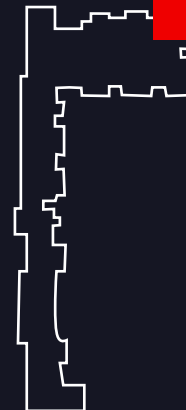

Preliminary views, subject to changes.
Vistas preliminares (Conceptuales) Sujetas a cambios

NAVÍO PUERTO SERENO
AT CAP CANA



Preliminary views, subject to changes.

Vistas preliminares (Conceptuales) Sujetas a cambios

Second Floor
Planta segundo piso

NAVÍO PUERTO SERENO
AT CAP CANA



Preliminary views, subject to changes.
Vistas preliminares (Conceptuales) Sujetas a cambios

Tipo B

Del 2do al 5to Nivel
Edif A
Apartamento 1 Hab

262.50 M2

[Apartamento = 191.00 M2]
[Terraza = 71.50 M2]
[4 Unidades]

- 1 Habitación
- Vestidor
- Sala comedor
- Cocina
- 2 Baños
- Terraza
- Lavado
- Servicio
- 1 Parqueo

Type B

From the 2nd al 5th Floor
Building A
Apartment 1 Bedroom

262.50 M2

[Apartment = 191.00 M2]
[Terrace = 71.50 M2]
[4 Units]

- 1 Bedroom
- Walking closet
- Living room / dining
- Kitchen
- 2 Bathroom
- Terraza
- Laundry area
- Service area
- 1 Parking spot

[EDIF.A]
A201
A301
A401
A501

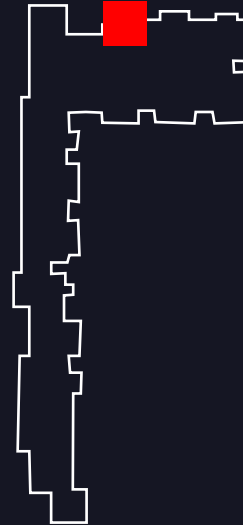

Preliminary views, subject to changes.
Vistas preliminares (Conceptuales) Sujetas a cambios

Tipo I

Del 2do al 5to Nivel
Edif A & B
Apartamento 2 Hab
+ Area de servicio

127.50 M2

[Apartamento = 110.00 M2]
[Balcon = 17.50 M2]
[16 Unidades]

- 2 Habitaciones
- 2 Vestidores
- Sala comedor
- Cocina
- 3.5 Baños
- Balcón
- Lavado
- Servicio
- 2 Parqueos

Type I

From the 2nd al 5th Floor
Building A & B
Apartment 2 Bedrooms
+ Service area

127.50 M2

[Apartment = 110.00 M2]
[Balcony = 17.50 M2]
[16 Units]

- 2 Bedrooms
- 2 Walking closets
- Living room / dining
- Kitchen
- 3.5 Bathroom
- Balcony
- Laundry Area
- Service area
- 2 Parking spots

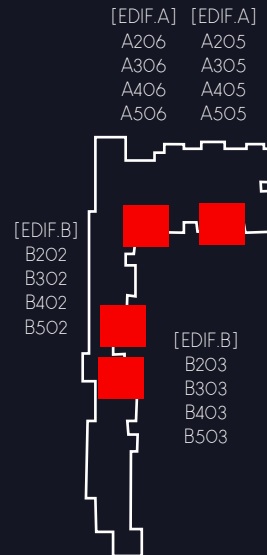

Preliminary views, subject to changes.
Vistas preliminares (Conceptuales) Sujetas a cambios

Tipo J

Del 2do al 5to Nivel
Edif C
Apartamento 3 Habs
+ Area de servicio

183.50 M2

[Apartamento = 151.50 M2]
[Balcon 1 = 20.00 M2]
[Balcony 2 = 12.00 M2]
[4 Unidades]

- 3 Habitaciones
- 3 Vestidores
- Sala comedor
- Cocina
- 4.5 Baños
- 2 Balcones
- Lavado
- Servicio
- 2 Parqueos

Type J

From the 2nd al 5th Floor
Buiding C
Apartment 3 Bedrooms
+ Service area

183.50 M2

[Apartment = 151.50 M2]
[Balcony 1 = 20.00 M2]
[Balcony 2 = 12.00 M2]
[4 Units]

- 3 Bedrooms
- 3 Walking closets
- Living room / dining
- Kitchen
- 4.5 Bathroom
- 2 Balconies
- Laundry area
- Service area
- 2 Parking spots

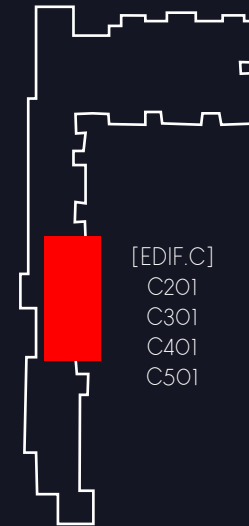

Preliminary views, subject to changes.
Vistas preliminares (Conceptuales) Sujetas a cambios

Tipo K

Del 2do al 5to Nivel
Edif C
Apartamento 3 Habs
+ Area de servicio

256.33 M2

[Apartamento = 191.00 M2]

[Balcon 1 = 19.50 M2]

[Balcon 2 = 35.50 M2]

[4 Unidades]

- 3 Habitaciones
- 3 Vestidores
- Sala comedor
- Cocina
- 4.5 Baños
- 2 Balcones
- Lavado
- Servicio
- 2 Parqueos

Type K

From the 2nd al 5th Floor
Building C
Apartment 3 Bedrooms
+ Service area

256.33 M2

[Apartment = 191.00 M2]

[Balcony 1 = 19.50 M2]

[Balcony 2 = 35.50 M2]

[4 Units]

- 3 Bedrooms
- 3 Walking closets
- Living room / dining
- Kitchen
- 4.5 Bathroom
- 2 Balconies
- Laundry area
- Service area
- 2 Parking spots

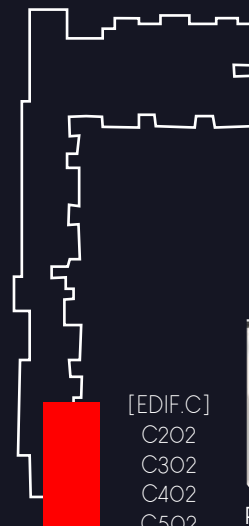

Preliminary views, subject to changes.
Vistas preliminares (Conceptuales) Sujetas a cambios

Tipo H

Del 2do al 5to Nivel
Edif A
Apartamento 2 Habs
+ Area de servicio

135.50 M2

[Apartamento = 110.00 M2]

[Balcon = 25.50 M2]

[4 Unidades]

- 2 Habitaciones
- 2 Vestidores
- Sala comedor
- Cocina
- 3.5 Baños
- Balcon
- Lavado
- Servicio
- 2 Parqueos

NAVÍO PUERTO SERENO
AT CAP CANA

Type H

From the 2nd al 5th Floor
Building A
Apartment 2 Bedrooms
+ Service area

135.50 M2

[Apartment = 110.00 M2]

[Balcony = 25.50 M2]

[4 Units]

- 2 Bedrooms
- 2 Walking closets
- Living room / dining
- Kitchen
- 3.5 Bathrooms
- Balcony
- Laundry area
- Service area
- 2 Parking spots



Preliminary views, subject to changes.
Vistas preliminares (Conceptuales) Sujetas a cambios

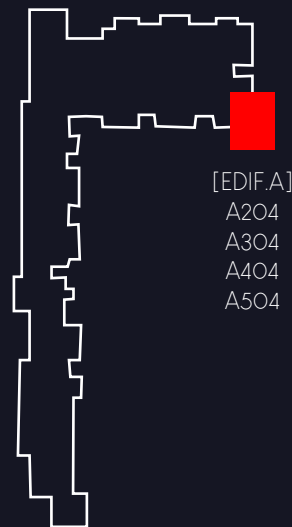

[EDIF. A]
A204
A304
A404
A504

Tipo G

Del 2do al 5to Nivel
Edif B
Apartamento 1 Hab

86.00 M2

[Apartamento = 70.50 M2]

[Balcon = 15.50 M2]

[4 Unidades]

- 1 Habitación
- 1 Vestidor
- Sala comedor
- Cocina
- 2 Baños
- Balcon
- Lavado
- 1 Parqueo

Type G

From the 2nd al 5th Floor
Building B
Apartment 1 Bedroom

86.00 M2

[Apartment = 70.50 M2]

[Balcony = 15.50 M2]

[4 Units]

- 1 Bedroom
- 1 Walking closets
- Living room / dining
- Kitchen
- 2 Bathrooms
- Balcony
- Laundry area
- 1 Parking spot

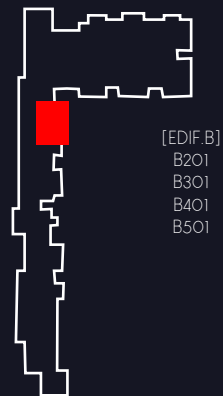

NAVÍO PUERTO SERENO
AT CAP CANA

Preliminary views, subject to changes.
Vistas preliminares (Conceptuales) Sujetas a cambios

Tipo D

Del 2do al 5to Nivel
Edif A
Apartamento 1 Hab

97.50 M2

[Apartamento = 74.00 M2]

[Balcon = 23.50 M2]

[4 Unidades]

- 1 Habitación
- 1 Vestidor
- Sala comedor
- Cocina
- 2 Baños
- Balcon
- Lavado
- 1 Parqueo

Type D

From the 2nd al 5th Floor
Building A
Apartment 1 Bedroom

97.50 M2

[Apartment = 74.00 M2]

[Balcony = 23.50 M2]

[4 Units]

- 1 Bedroom
- 1 Walking closets
- Living room / dining
- Kitchen
- 2 Bathrooms
- Balcony
- Laundry area
- 1 Parking spot



NAVÍO PUERTO SERENO
AT CAP CANA

Preliminary views, subject to changes.
Vistas preliminares (Conceptuales) Sujetas a cambios

Tipo C

Del 2do al 5to Nivel
Edif A
Apartamento 1 Hab

91.50 M2

[Apartamento = 74.00 M2]

[Balcon = 17.50 M2]

[4 Unidades]

- 1 Habitación
- 1 Vestidor
- Sala comedor
- Cocina
- 2 Baños
- Balcon
- Lavado
- 1 Parqueo

Type C

From the 2nd al 5th Floor
Buiding A
Apartment 1 Bedroom

91.50 M2

[Apartment = 74.00 M2]

[Balcony = 17.50 M2]

[4 Units]

- 1 Bedroom
- 1 Walking closets
- Living room / dining
- Kitchen
- 2 Bathrooms
- Balcony
- Laundry area
- 1 Parking spot

[EDIF. A
A202
A302
A502
A503



Preliminary views, subject to changes.
Vistas preliminares (Conceptuales) Sujetas a cambios



Preliminary views, subject to changes.
Vistas preliminares (Conceptuales) Sujetas a cambios

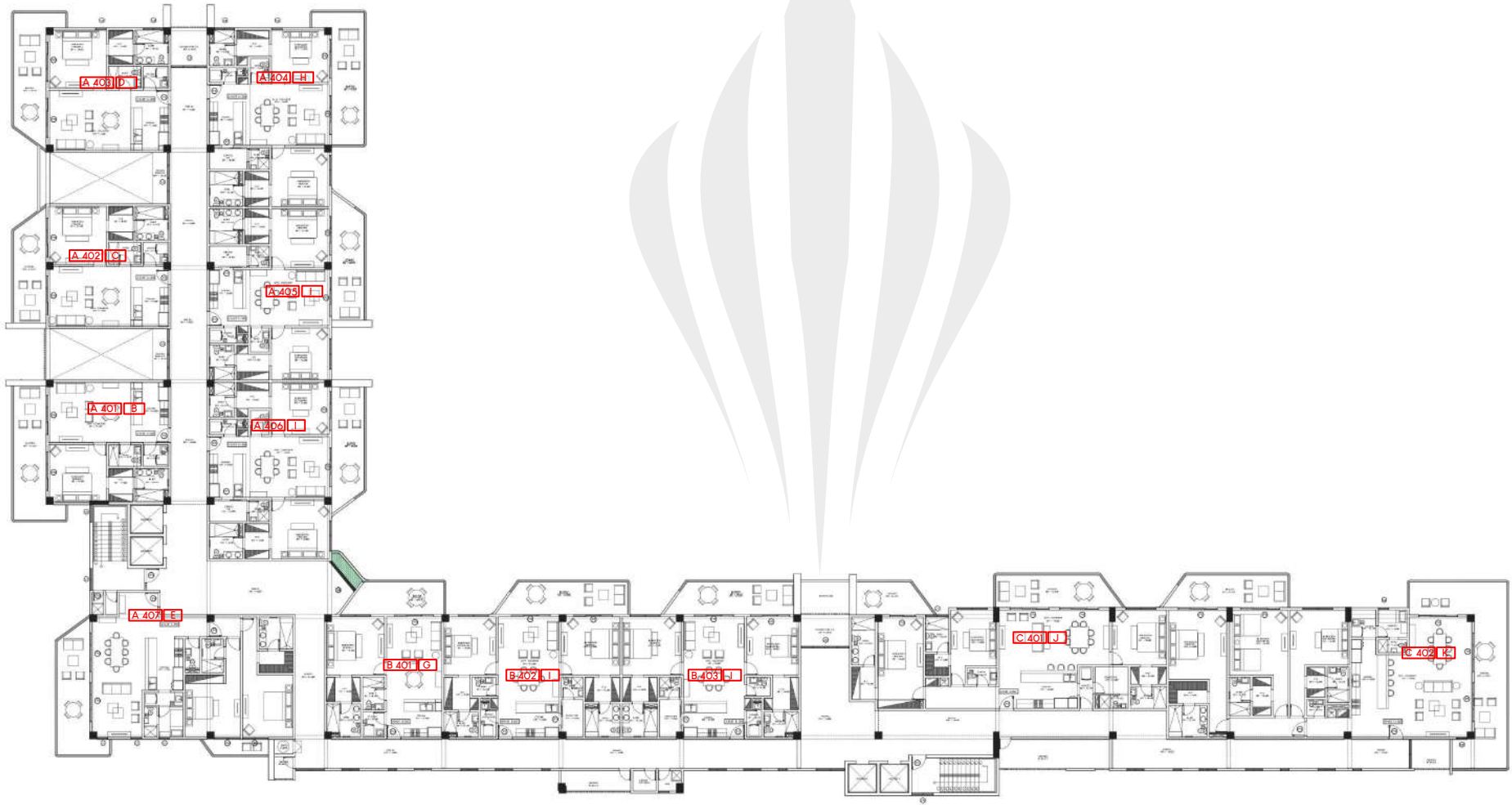

Preliminary views, subject to changes.
Vistas preliminares (Conceptuales) Sujetas a cambios

Fifth Floor
Planta quinto piso

NAVÍO PUERTO SERENO
AT CAP CANA



Preliminary views, subject to changes.
Vistas preliminares (Conceptuales) Sujetas a cambios





Enjoy the many premium amenities that elevate the experience of living in front of the Caribbean Sea and the profitability of these sophisticated apartments.

Disfruta de abundantes amenidades premium que elevan la experiencia de vivir frente al Mar Caribe y la rentabilidad de estos sofisticados apartamentos.

Preliminary views, subject to changes.
Vistas preliminares (Conceptuales) Sujetas a cambios

NAVÍO PUERTO SERENO
AT CAP CANA

Pent A2

6to Nivel
Edif A
Penthouse 2 Habs
+ Area de servicio

242.50 M2

[Apartamento = 170.00 M2]
[Balcon = 28.00 M2]
[Terraza = 44.50 M2]
[1 Unidad]

- 2 Habitaciones
- 1 Vestidor
- 1 Closet
- Sala comedor
- Cocina
- 3 Baños y 2 medios
- Balcon
- Lavado
- Terraza
- Servicio
- 2 Parqueo

Pent A2

6th Floor
Building A
Penthouse 2 Bedrooms
+ Service Area

242.50 M2

[Apartment = 170.00 M2]
[Balcony = 28.00 M2]
[Terrace = 44.50 M2]
[1 Unit]

- 2 Bedrooms
- 1 Walking closet
- 1 Closet
- Living room / dining
- Kitchen
- 3 Bathrooms and 2 halves
- Balcony
- Laundry area
- Terrace
- Service area
- 1 Parking spot



Preliminary views, subject to changes.
Vistas preliminares (Conceptuales) Sujetas a cambios

[EDIF.A]
A607



Pent K2

6to Nivel
Edif C
Penthouse 3 Habs
+ Area de servicio

379.00 M2

[Apartamento = 241.00 M2]
[Balcon 1 = 19.50 M2]
[Balcon 2 = 35.50 M2]
[Terraza = 83.00 M2]
[1 Unidad]

- 3 Habitaciones
- 3 Vestidores
- Sala comedor
- Cocina
- 4 Baños y 2 medios
- 2Balcones
- Lavado
- Terraza
- Servicio
- 3 ParqueoS

Pent K2

6th Floor
Building C
Penthouse 3 Bedrooms
+ Service Area

379.00 M2

[Apartment = 241.00 M2]
[[Balcony 1 = 19.50 M2]
[Balcony 2 = 35.50 M2]
[Terrace = 83.00 M2]
[1 Unit]

- 3 Bedrooms
- 3 Walking closet
- Living room / dining
- Kitchen
- 4 Bathrooms and 2 halves
- 2 Balconies
- Laundry area
- Terrace
- Service area
- 3 Parking spot



Preliminary views, subject to changes.
Vistas preliminares (Conceptuales) Sujetas a cambios



Pent J2

6to Nivel
Edif C
Penthouse 3 Habs
+ Area de servicio

299.50 M2

[Apartamento = 192.50 M2]
[Balcon 1 = 20.00 M2]
[Balcon 2 = 12.00 M2]
[Terraza = 75.00 M2]
[1 Unidad]

- 3 Habitaciones
- 3 Vestidores
- Sala comedor
- Cocina
- 4.5 Baños
- 2Balcones
- Lavado
- Terraza
- Servicio
- 3 Parqueo

Pent J2

6th Floor
Building C
Penthouse 3 Bedrooms
+ Service Area

299.50 M2

[Apartment = 192.50 M2]
[[Balcony 1 =20.00 M2]
[Balcony 2 = 12.00 M2]
[Terrace = 75.00 M2]
[1 Unit]

- 3 Bedrooms
- 3 Walking closet
- Living room / dining
- Kitchen
- 4.5 Bathrooms
- 2 Balconies
- Laundry area
- Terrace
- Service area
- 3 Parking spot



Preliminary views, subject to changes.
Vistas preliminares (Conceptuales) Sujetas a cambios

Pent 12

6to Nivel
Edif A & B
Penthouse 2 Habs
+ Area de servicio

211.50 M2

[Apartamento = 144.50 M2]
[Balcon = 17.50 M2]
[Terraza = 49.50 M2]
[4 Unidades]

- 2 Habitaciones
- 2 Vestidores
- Sala comedor
- Cocina
- 3.5 Baños
- Balcon
- Lavado
- Terraza
- Servicio
- 2 Parqueo

Pent 12

6th Floor
Building A & B
Penthouse 2 Bedrooms
+ Service Area

211.50 M2

[Apartment = 144.50 M2]
[[Balcony = 17.50 M2]
[Terrace = 49.50 M2]
[4 UnitS]

- 2 Bedrooms
- 2 Walking closet
- Living room / dining
- Kitchen
- 3.5 Bathrooms
- Balcony
- Laundry area
- Terrace
- Service area
- 2 Parking spots



Preliminary views, subject to changes.
Vistas preliminares (Conceptuales) Sujetas a cambios

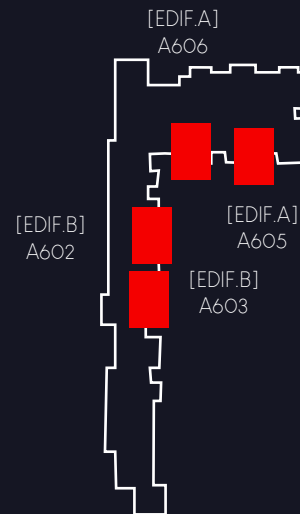

Pent G2

6to Nivel
Edif B
Penthouse 1 Hab

157.50 M2

[Apartamento = 102.50 M2]
[Balcon = 15.50 M2]
[Terraza = 39.50 M2]
[1 Unidad]

- 1 Habitación
- 1 Vestidor
- Sala comedor
- Cocina
- 1.5 Baños
- Balcon
- Lavado
- Terraza
- 1 Parqueo

Pent G2

6th Floor
Building B
Penthouse 1 Bedroom

157.50 M2

[Apartment = 102.50 M2]
[[Balcony = 15.50 M2]
[Terrace = 39.50 M2]
[1 Unit]

- 1 Bedroom
- 1 Walking closet
- Living room / dining
- Kitchen
- 1.5 Bathrooms
- Balcony
- Laundry area
- Terrace
- 1 Parking spot



Preliminary views, subject to changes.
Vistas preliminares (Conceptuales) Sujetas a cambios

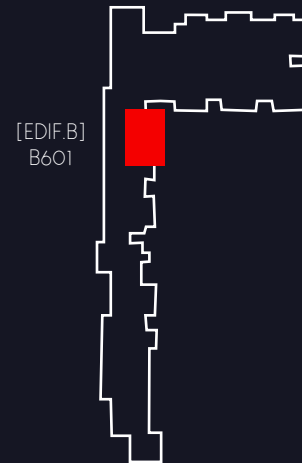

Pent G2

6to Nivel
Edif A
Penthouse1 Hab

179.00 M2

[Apartamento = 107.00 M2]
[Balcon = 23.50 M2]
[Terraza = 48.50 M2]
[1 Unidad]

- 1 Habitación
- 1 Vestidor
- Sala comedor
- Cocina
- 1.5 Baños
- Balcon
- Lavado
- Terraza
- 1 Parqueo

Pent G2

6th Floor
Building A
Penthouse 1 Bedroom

179.00 M2

[Apartment = 107.00 M2]
[[Balcony = 23.50 M2]
[Terrace = 48.50 M2]
[1 Unit]

- 1 Bedroom
- 1 Walking closet
- Living room / dining
- Kitchen
- 1.5 Bathrooms
- Balcony
- Laundry area
- Terrace
- 1 Parking spot



Preliminary views, subject to changes.
Vistas preliminares (Conceptuales) Sujetas a cambios

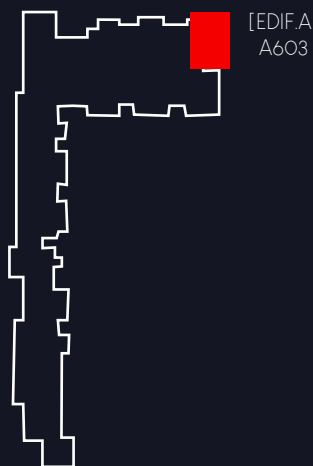

Pent F2

6to Nivel
Edif A
Penthouse 2 Habs
+ Area de servicio

276.50 M2

[Apartamento = 156.00 M2]
[Balcon = 25.50 M2]
[Terraza = 95.00 M2]
[1 Unidad]

- 2 Habitaciones
- 2 Vestidores
- Sala comedor
- Cocina
- 4 Baños
- Balcon
- Lavado
- Terraza
- Servicio
- 2 Parqueo

Pent F2

6th Floor
Building A
Penthouse 2 Bedrooms
+ Service Area

276.50 M2

[Apartment = 156.00 M2]
[[Balcony = 25.50 M2]
[Terrace = 95.00 M2]
[1 Unit]

- 2 Bedrooms
- 2 Walking closet
- Living room / dining
- Kitchen
- 4 Bathrooms
- Balcony
- Laundry area
- Terrace
- Service area
- 2 Parking spot



Preliminary views, subject to changes.
Vistas preliminares (Conceptuales) Sujetas a cambios



Pent B2

6to Nivel
Edif A
Penthouse 1 Hab

180.00 M2

[Apartamento = 107.00 M2]
[Balcon = 45.50 M2]
[Terraza = 48.50 M2]
[1 Unidad]

- 1 Habitación
- 1 Vestidor
- Sala comedor
- Cocina
- 1.5 Baños
- Balcon
- Lavado
- Terraza
- 1 Parqueo

Pent B2

6th Floor
Building A
Penthouse 1 Bedroom

180.00 M2

[Apartment = 107.00 M2]
[[Balcony = 24.50 M2]
[Terrace = 48.50 M2]
[1 Unit]

- 1 Bedroom
- 1 Walking closet
- Living room / dining
- Kitchen
- 1.5 Bathrooms
- Balcony
- Laundry area
- Terrace
- 1 Parking spot

[EDIF.A]
A601

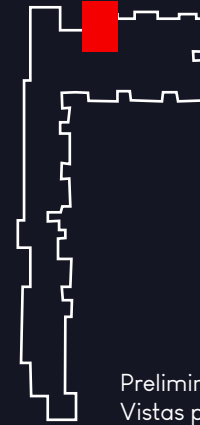

Preliminary views, subject to changes.
Vistas preliminares (Conceptuales) Sujetas a cambios



Pent C2

6to Nivel
Edif A
Penthouse 1 Hab

173.53 M2

[Apartamento = 106.64 M2]
[Balcon = 17.53 M2]
[Terraza = 50.00 M2]
[1 Unidad]

- 1 Habitación
- 1 Vestidor
- Sala comedor
- Cocina
- 1.5 Baños
- Balcon
- Lavado
- Terraza
- 1 Parqueo

Pent C2

6th Floor
Building A
Penthouse 1 Bedroom

173.53 M2

[Apartment = 106.64 M2]
[[Balcony = 17.53 M2]
[Terrace = 50.00 M2]
[1 Unit]

- 1 Bedroom
- 1 Walking closet
- Living room / dining
- Kitchen
- 1.5 Bathrooms
- Balcony
- Laundry area
- Terrace
- 1 Parking spot



[EDIF.A]
A602

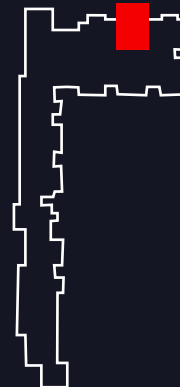

Preliminary views, subject to changes.
Vistas preliminares (Conceptuales) Sujetas a cambios



NAVÍO

PUERTO SERENO
AT CAP CANA

(+1) 809 669 3958 - (+1) 829 471 5568

www.naviodr.com

[@naviopuertosereno](https://www.instagram.com/naviopuertosereno)

info@naviodr.com