



EL SALVADOR REAL ESTATE

Compra, venta y
alquiler de propiedades.

 (503) 7469-9505

www.calvobienesraices.com



PLAYA Y ESTERO
EN EL MISMO LUGAR



KM 76

BOULEVARD
COSTA DEL SOL



Costa Dorada
está conformada por
16 manzanas en la playa Costa del Sol
y 11 manzanas colindantes
con el Estero de Jaltepeque,
integradas por un paso a desnivel vehicular.

Desde helipuerto hasta Wellness Center,
vive rodeado de las mejores
amenidades.



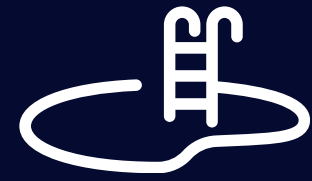

7 piscinas



Cancha de tenis



Casa Club



69 hangares



Helipuerto



Gasolinera



Locales comerciales



[Video de proyecto Costa Dorada](#)



TIPOLOGÍA DE LOTES

LOTE A

13 X 39 = 507 mts²

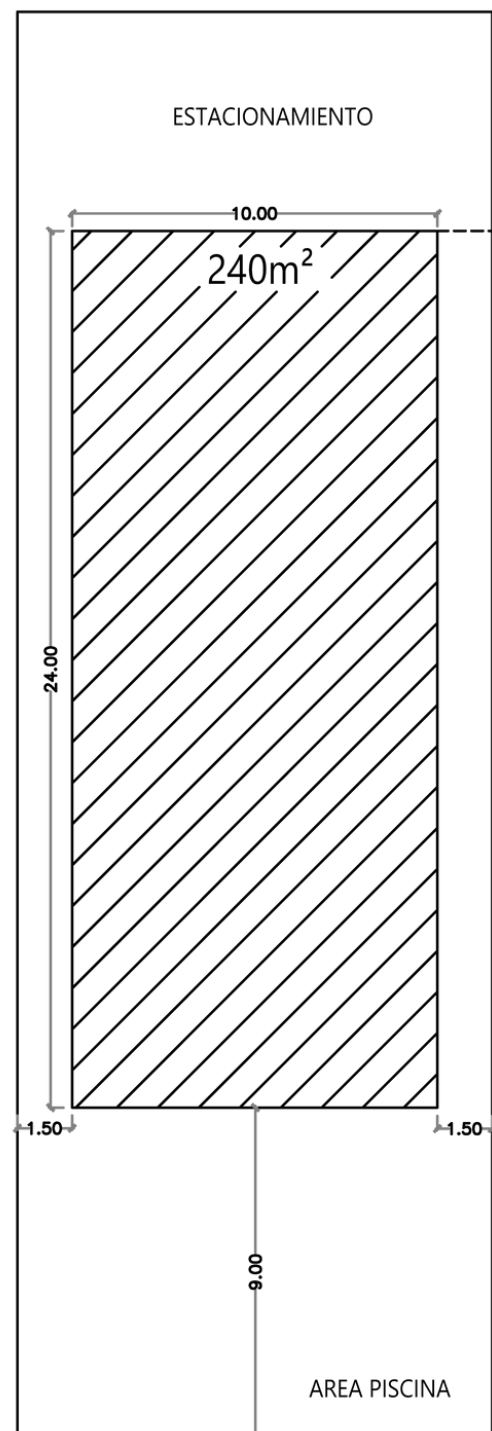

PLAYA

LOTE B

12 X 36 = 432 mts²

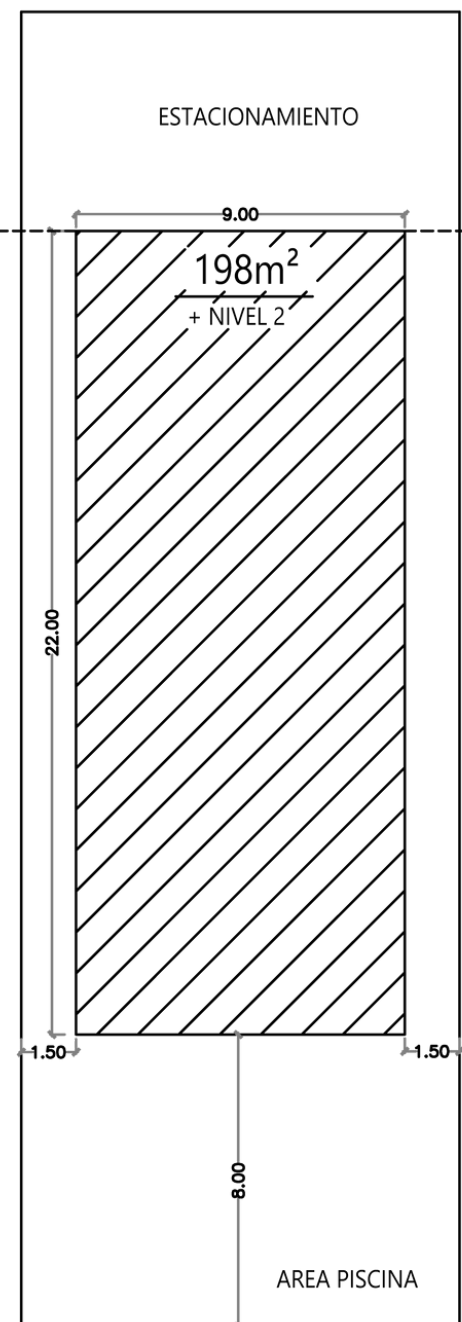

AREA VERDE

LOTE C

11 X 33 = 363 mts²

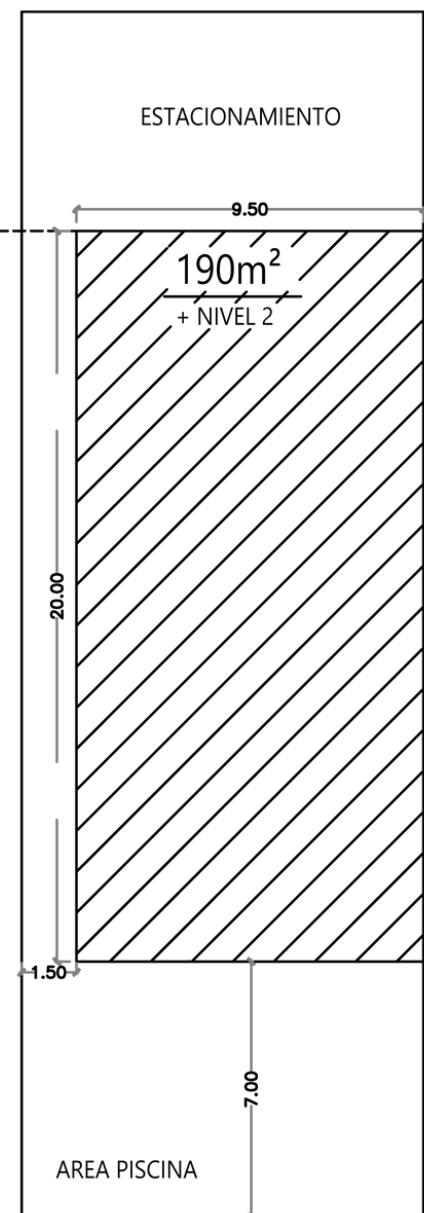

AREA VERDE

LOTE D/EF

10 X 30 = 300 mts²

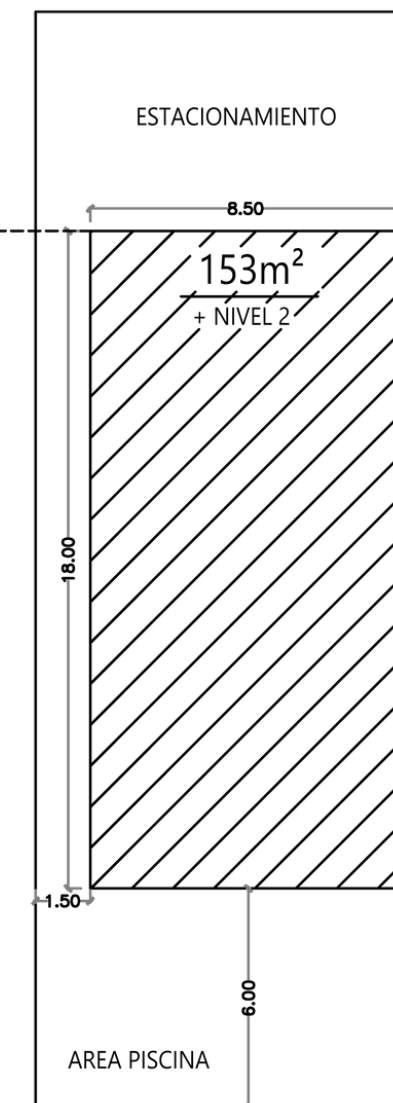

AREA VERDE

LOTE E/EE

9 X 27 = 243 mts²

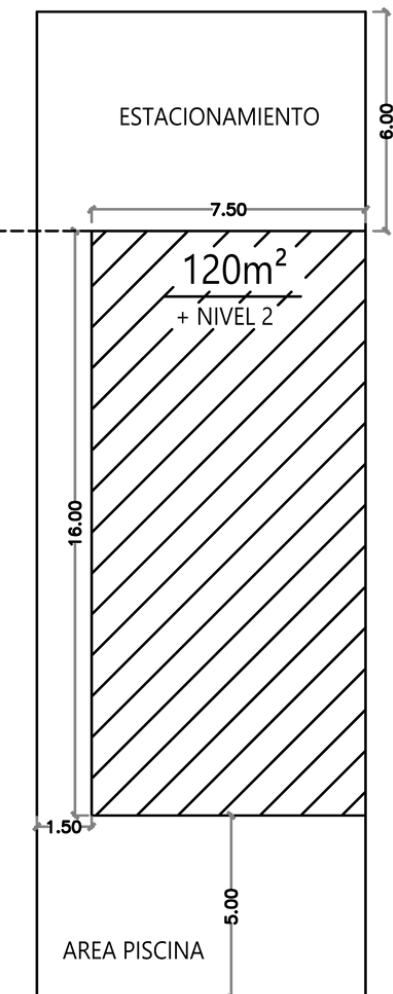

AREA VERDE

LOTE A

PRECIO:
US \$: 210,000

RESERVA:
US \$: 21,000

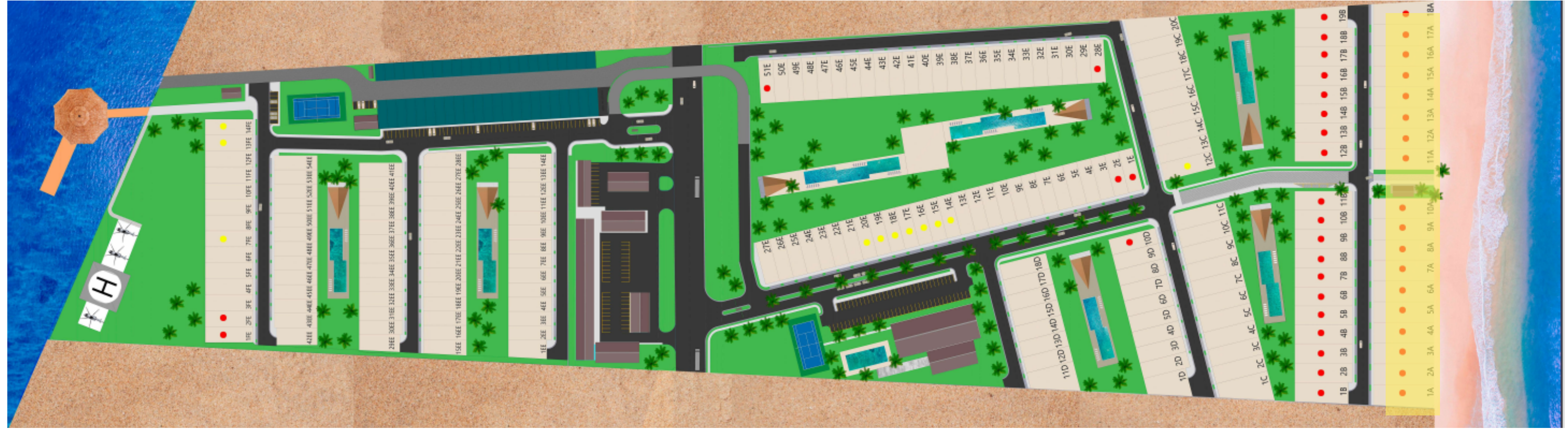

LOTE B

PRECIO:
US \$: 175,000

RESERVA:
US \$: 17,500

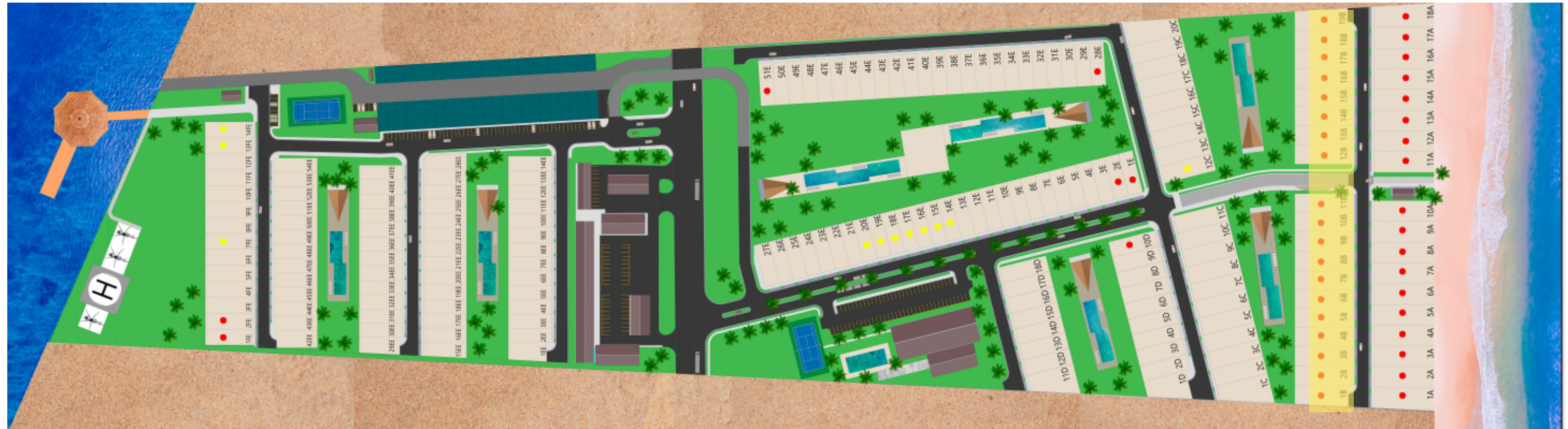

LOTE C

PRECIO:
US \$: 160,000

RESERVA:
US \$: 16,000

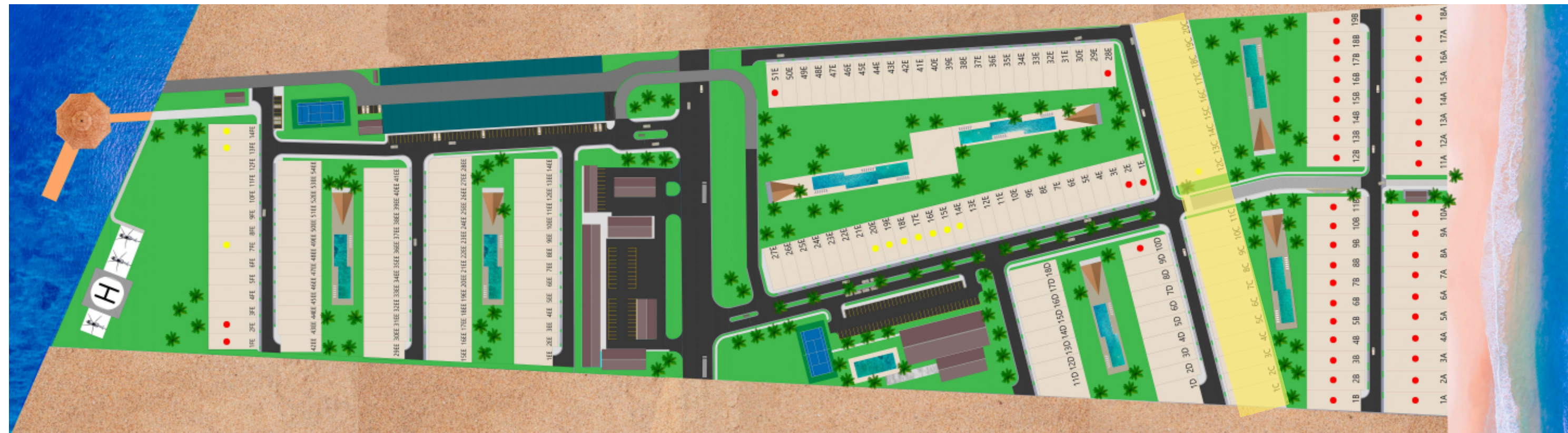

LOTE D

PRECIO:
US \$: 160,000

RESERVA:
US \$: 16,000

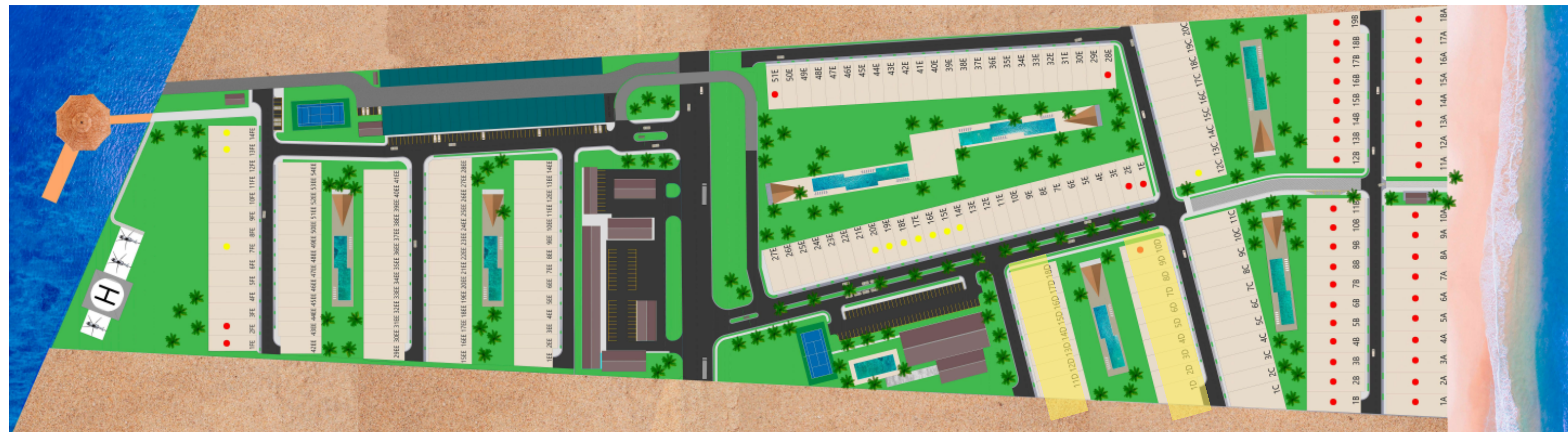

LOTE E

PRECIO:
US \$: 135,000

RESERVA:
US \$: 13,500

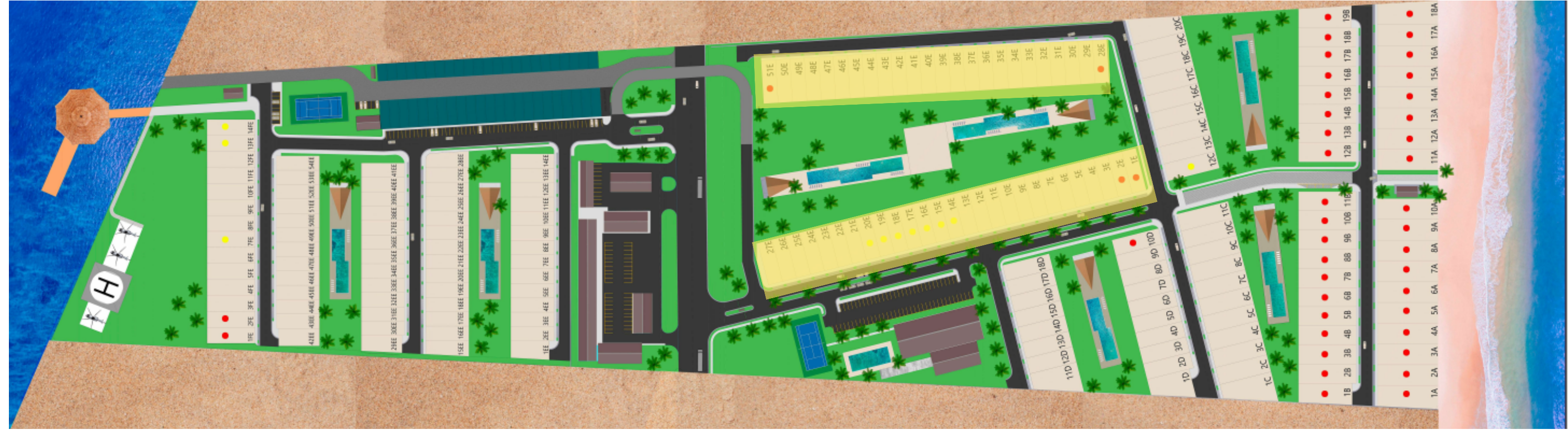

LOTE EE

PRECIO:
US \$: 135,000

RESERVA:
US \$: 13,500

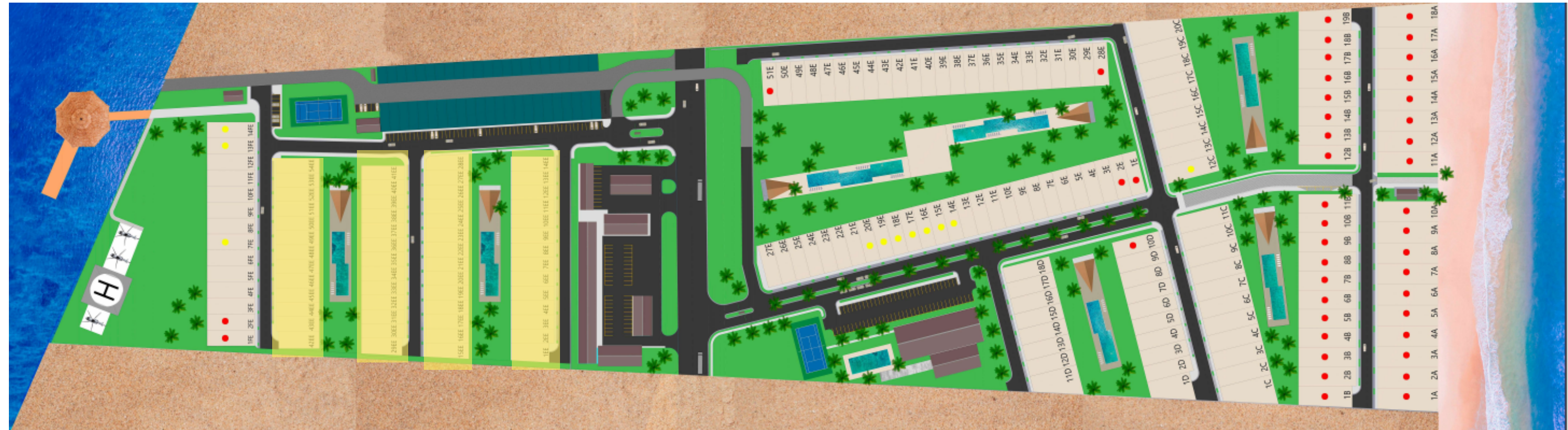

LOTE EF

PRECIO:
US \$: 175,000

RESERVA:
US \$: 17,500

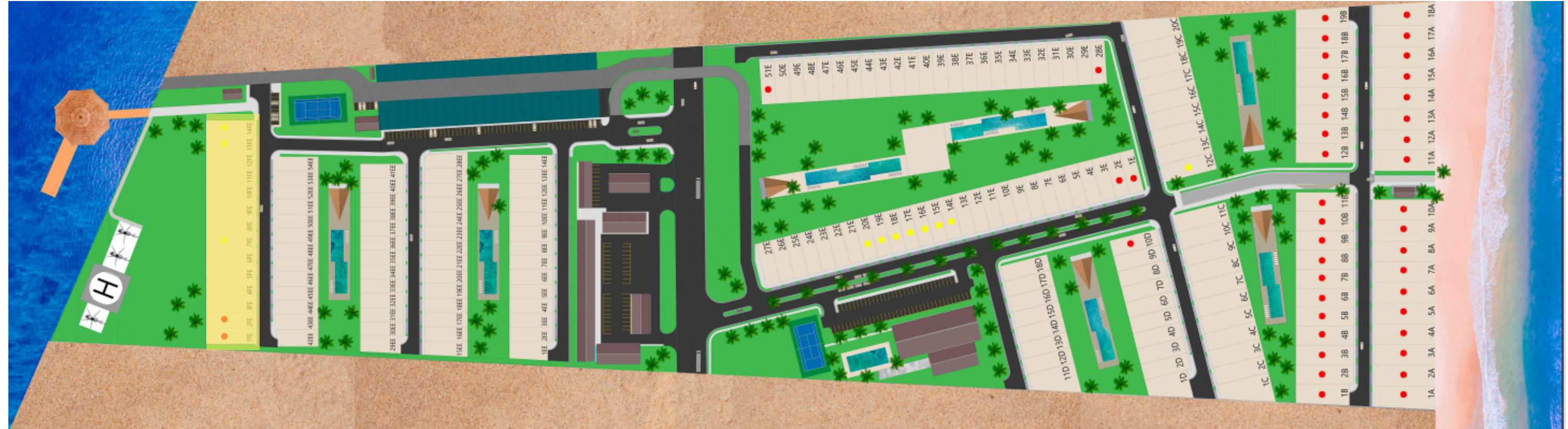

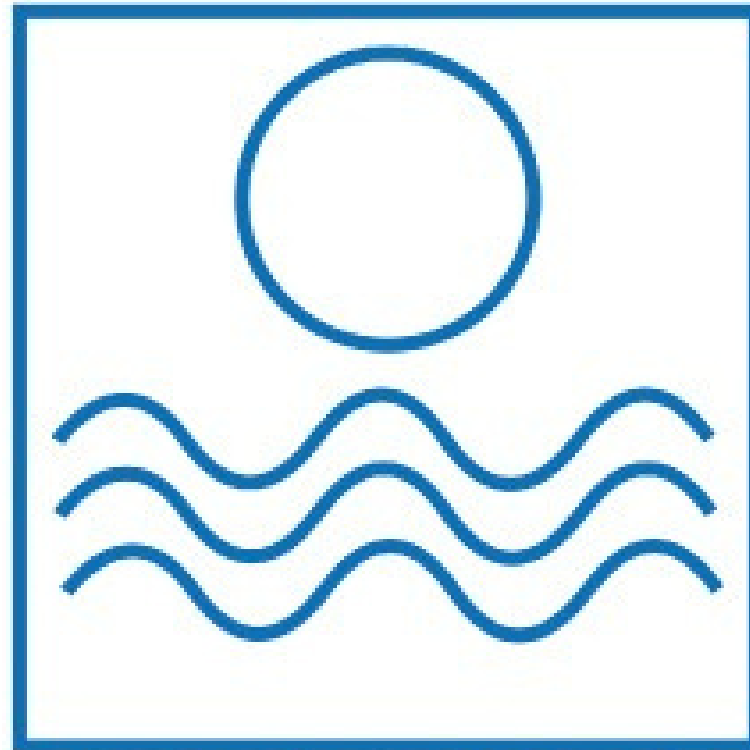

COSTA DORADA

¡RESERVA TU LOTE AHORA!

(503) 7469-9505

calvobienesraices.sv@gmail.com

www.calvobienesraices.com