

PROPIEDAD PRIVADA

GRANJA SANTA FE

TABLA DE DATOS		
AREA TOTAL	308,428.246 m ²	100.000%
AREA TOTAL VENDIBLE	229,012.656 m ²	74.252%
AREA TOTAL DE CALLES	50,317.974 m ²	16.314%
AREA VERDE	18,337.141 m ²	5.945%
AREA DE CONSERVACION	10,760.475 m ²	3.489%

LOTE	AREA m ²
1	3,450.521
2	2,504.814
3	3,216.224
4	1,216.190
5	1,216.216
6	1,243.070
7	1,239.080
8	1,230.505
9	1,242.708
10	1,196.939
11	1,202.594
12	1,214.507
13	1,208.042
14	1,198.825
15	1,189.609
16	1,180.393
17	1,171.927
18	1,169.889
19	1,168.857
20	1,380.107
21	1,155.890
22	1,433.140
23	1,429.515
24	1,425.325
25	1,420.967
26	1,416.610
27	1,404.341
28	1,399.221
29	1,397.676
30	1,395.506
31	1,395.780
32	1,396.873
33	1,396.229
34	1,318.069
35	1,320.000
36	1,320.000
37	1,320.000
38	1,320.000
39	1,320.000
40	1,320.000
41	1,320.000
42	1,320.000
43	1,320.000
44	1,320.000
45	1,320.000
46	1,320.000
47	1,320.000
48	1,320.000
49	2,125.809
50	1,318.069

LOTE	AREA m ²
50	1,318.069
51	1,320.000
52	1,320.000
53	1,320.000
54	1,320.000
55	1,320.000
56	1,320.000
57	1,320.000
58	1,320.000
59	1,320.000
60	1,320.000
61	1,320.000
62	1,311.031
63	1,316.862
64	2,234.268
65	1,594.864
66	2,017.319
67	1,992.863
68	1,320.000
69	1,320.000
70	1,320.000
71	1,640.356
72	1,424.232
73	1,426.163
74	1,426.163
75	1,426.163
76	1,426.163
77	1,426.163
78	1,426.163
79	1,426.163
80	1,426.163
81	3,144.540
82	1,424.232
83	1,426.163
84	1,426.163
85	1,426.163
86	1,426.163
87	1,426.163
88	1,426.163
89	1,329.037
90	1,069.945
91	2,343.939
92	1,426.167
93	1,426.167
94	1,426.166
95	1,426.166
96	1,426.167
97	1,426.166
98	1,743.506
99	1,675.219
100	1,418.376

LOTE	AREA m ²
101	1,426.166
102	1,426.078
103	1,426.166
104	1,426.166
105	1,426.166
106	1,426.166
107	1,426.166
108	1,426.166
109	1,795.763
110	395.855
111	913.019
112	1,313.567
113	1,316.377
114	1,315.189
115	1,321.999
116	1,324.810
117	1,327.524
118	1,328.645
119	1,315.736
120	1,798.131
121	1,318.069
122	1,746.369
123	1,320.000
124	1,341.848
125	1,320.000
126	925.961
127	1,830.074
128	1,414.187
129	998.300
130	737.661
131	2,432.146
132	1,133.803
133	1,135.230
134	1,132.623
135	1,130.016
136	1,127.409
137	1,125.574
138	1,117.415
139	1,111.131
140	1,104.847
141	1,098.562
142	1,092.278
143	1,211.029
144	1,565.052
145	1,784.245
146	1,944.650
147	2,416.887
148	1,611.407
149	1,383.568
150	1,408.000
151	1,408.000
152	1,405.000
153	2,230.707
154	2,428.675
155	1,417.010
156	1,395.975
157	1,372.250
158	1,366.036
159	1,593.568
160	1,623.327
161	1,629.848
162	10,364.620

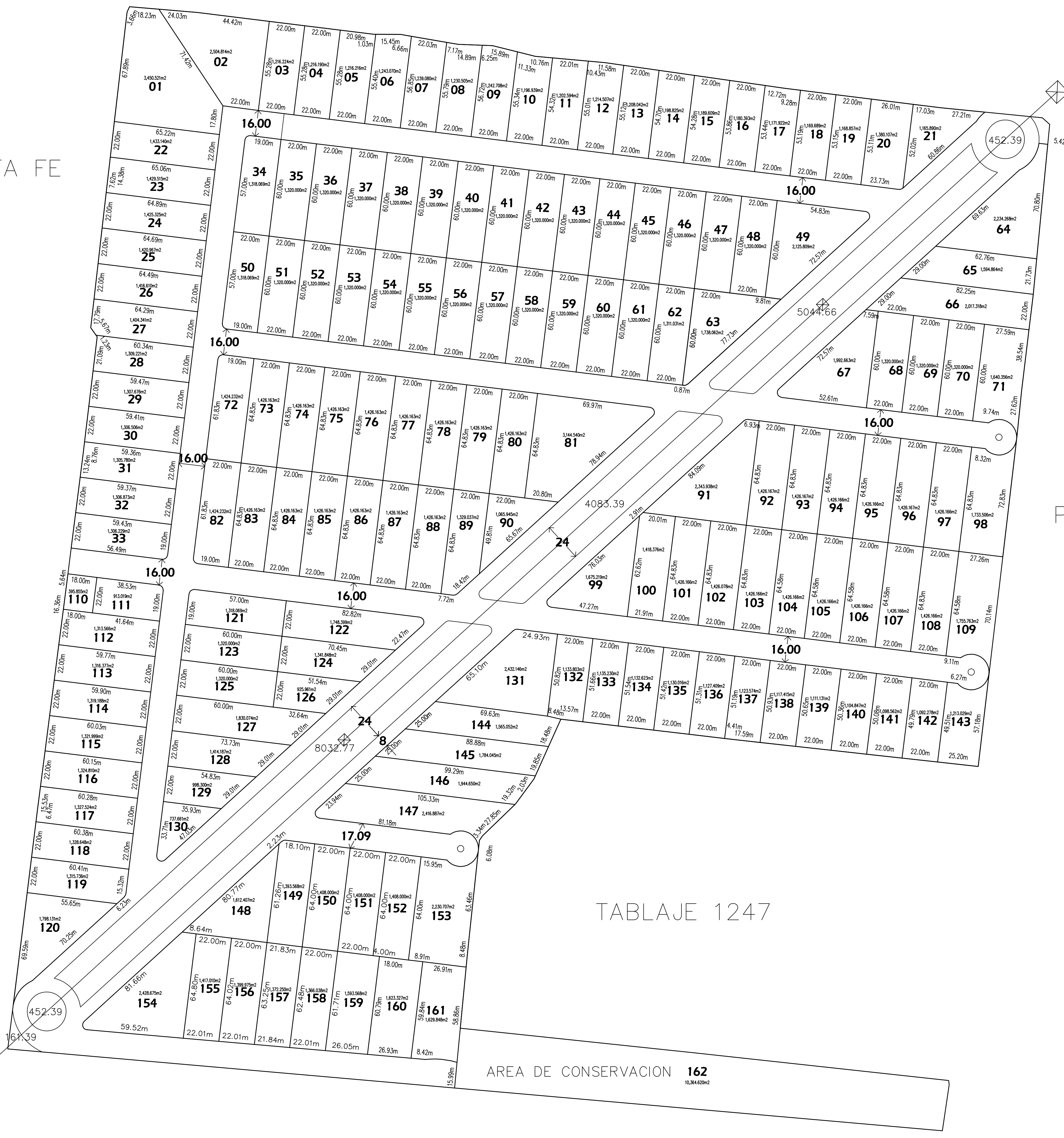

PLANO TOPOGRAFICO

IDENTIFICACION GEOGRAFICA

ESTADO: YUCATAN
 MUNICIPIO: UMAN
 PROYECTO: POXILA

SIMBOLOGIA

LIMITES

- LIMITES INTERNACIONAL
- - - - - LIMITES ESTATALES
- - - - - LIMITES MUNICIPALES
- LIMITES CATASTRALES
- LIMITES DE MANIOBRAS
- LIMITES DE PARCELAS
- LIMITES DE SOLAR URBANO
- LIMITES DE INFRAESTRUCTURA
- LIMITES DE AREAS ESPECIALES

VAS DE COMUNICACION

- CARRETERA PAVIMENTADA FEDERAL
- TERRACERA BIEDRA
- PUENTE
- FERROCARRIL

LINEAS DE CONDUCCION

- CONDUCTOR AEREO
- CONDUCTOR SUBTERRANEO
- ELECTRICIDAD
- TELEFONIA
- TELEVISION
- TORRE ELECTRICA

HIDROGRAFIA

- LAGO, LAGUNA, ESTERCO
- RIO PERMANENTE, ARROYO, BARRANCA
- PRESA, REPRESA, REPRESAL, PRESITA, DIQUE
- BARRIO, OLLA DE AGUA, ANADIL, APREVEDADO
- DEPÓSITO DE AGUA, TANQUE, ESTANQUE
- CANTONAMIENTO, ZONA
- POZO, BOMBA DE AGUA

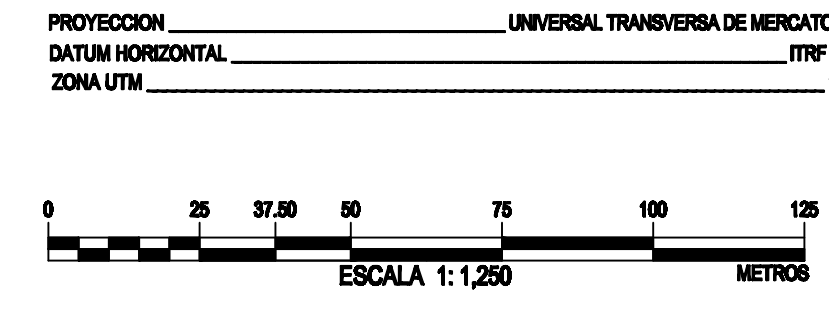

RESPONSABLE DEL LEVANTAMIENTO
 TOPOGRAFICO PEDRO RUIZ ALONSO CRESPINO