





WELCOME HOME



WHERE HOME AND  
NATURE BECOME ONE



Located in Tankah Bay, just a few miles from the city of Tulum, Mexico.

Surrounded by archaeological sites, breathtaking natural attractions and a rich culture, Tankah Bay is one of the most exclusive and luxurious beachfront communities in the Mayan Riviera.

TANKAH 52

CASA CENOTE

LOCATION

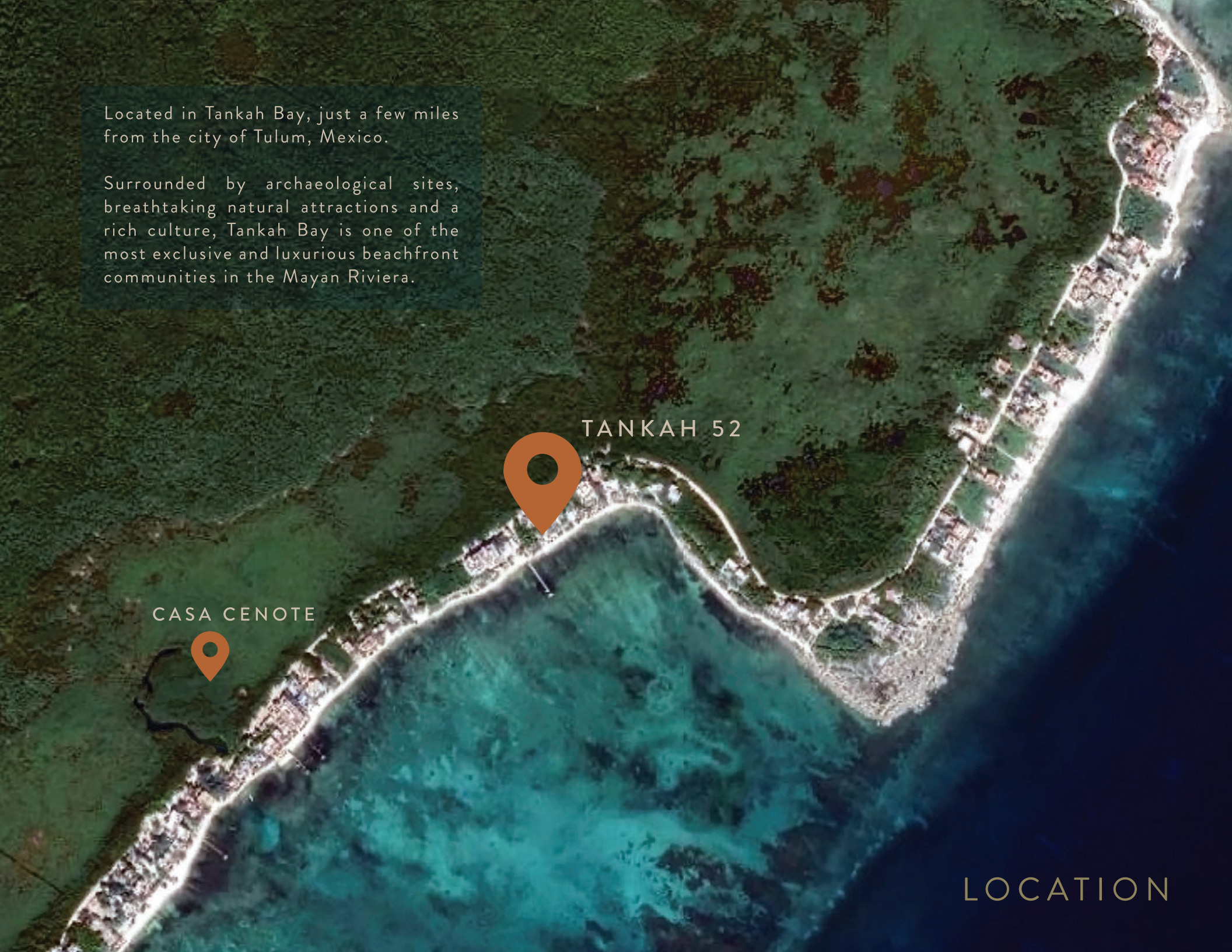

LUXURY UNMATCHED  
BY ANY OTHER



Facade screen that mirrors the lush mangrove forrest



The background of the entire page is a photograph of a tropical sunset. The sky is a gradient of light blue at the top to a bright orange and yellow near the horizon. Two palm trees are silhouetted against the sky, one on the left and one on the right. In the center, a person is silhouetted against the bright sun, standing on a grassy hill. The overall mood is serene and peaceful.

## TANKAH —52—

With a sophisticated and organic architectural character, Tankah 52 is able to combine comfort, amenities and tranquility with a luxurious lifestyle that coexists organically with its natural setting.

Comprised of two towers, with a total of 24 incredible condominium residences, a lobby, rooftop lounge, sun deck and pool with a swim up bar.

Sustainable solutions and ecotechnologies are an important aspect of this project, all of which will further aid in peacefully integrating Tankah 52 with its gorgeous surroundings.

Enjoy your very own slice of paradise in this stunning beachfront development. Escape city life and surround yourself with bright turquoise water, shimmering white sand and lush green jungle.



# THE LEGACY RESIDENCE

## GARDEN LEVEL

This is your legacy.

Filled with natural light pouring in from the full length glass murals which give incredible panoramic views of the ocean, the bay or the jungle, our garden level residences have immediate access to all the amenities and are just a few steps away from the beach.



# THE LEGACY

TOTAL AREA: 1,836 ft<sup>2</sup> / 170.57 m<sup>2</sup>

INTERIOR AREA: 1,602.96 ft<sup>2</sup> / 148.92 m<sup>2</sup>

TERRACE: 233.04 ft<sup>2</sup> / 21.65 m<sup>2</sup>

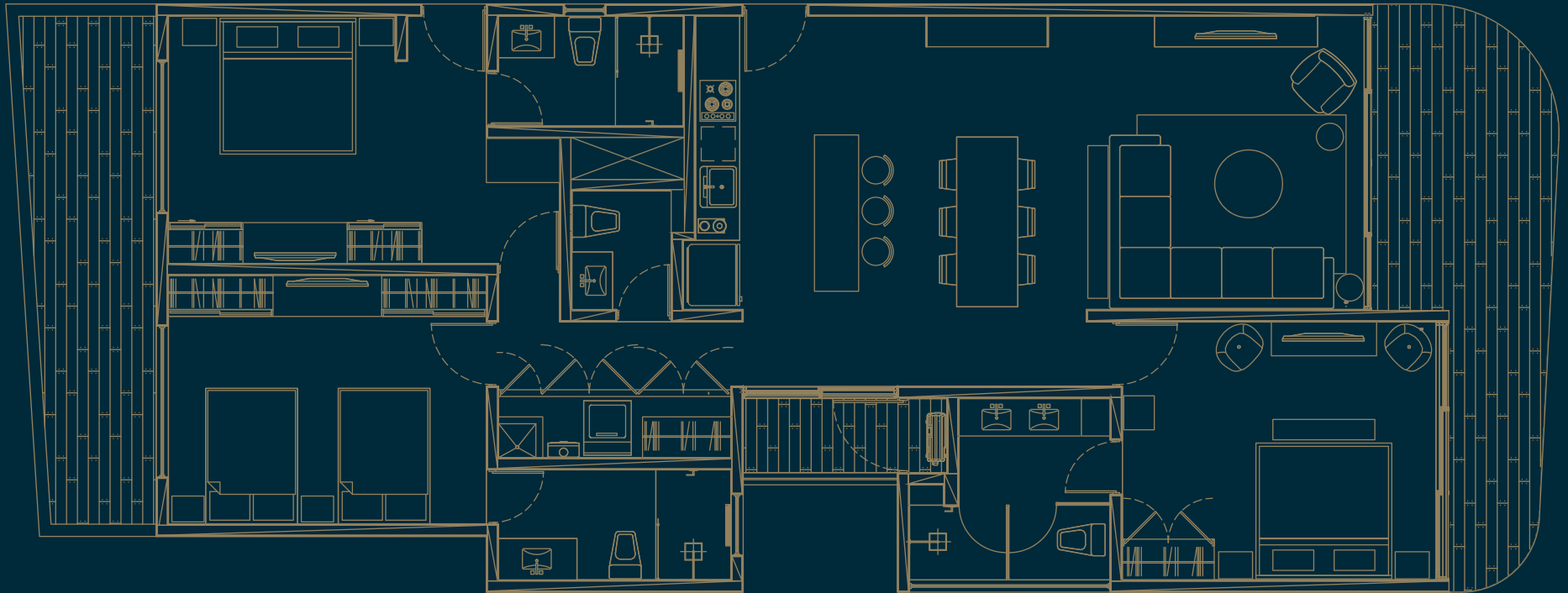

THREE BEDROOMS



LIVING ROOM



LAUNDRY SYSTEM



TWO FULL BATHS



DINING ROOM



TWO TERRACES



ONE HALF BATH



FULL KITCHEN



OCEAN VIEW

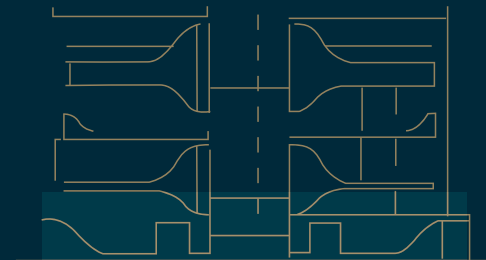

DARE TO FIND YOUR BLISS



# THE LIMITLESS RESIDENCE

## SECOND LEVEL

Unlimited beauty.

With trendy, rustic chic interiors created by one of the best interior designers of the moment, our second level residences offer incredible views without limit.

The open space concept with warm tones and natural decor invite a peaceful and relaxing experience.



# THE LIMITLESS

TOTAL AREA: 1,880.46 ft<sup>2</sup> / 174.70 m<sup>2</sup>

INTERIOR AREA: 1,391.77 ft<sup>2</sup> / 129.30 m<sup>2</sup>

TERRACE: 488.68 ft<sup>2</sup> / 45.40 m<sup>2</sup>



TWO BEDROOMS



LIVING ROOM



LAUNDRY SYSTEM



TWO FULL BATHS



DINING ROOM



TWO TERRACES



ONE HALF BATH



FULL KITCHEN



OCEAN VIEW

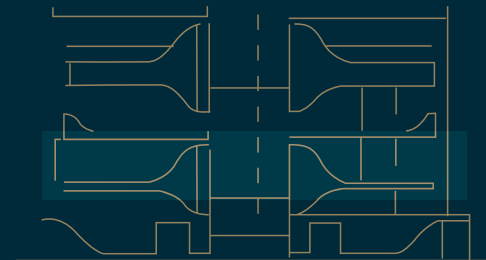

A tropical beach scene at sunset or sunrise. In the foreground, the fronds of a palm tree hang down from the top right. The sky is a mix of blue and orange, with a single bird in flight in the center. A long wooden pier extends from the beach into the ocean, ending in a small thatched hut. The beach is white sand, and the water is calm and clear.

LIVE THE LIFE OF YOUR DREAMS

# THE MAGNIFICENT RESIDENCE

## THIRD LEVEL

Magical views of the magnificent mayan jungle and beach.

One of the amazing features of the third level is the height of the ceilings (13ft/4m) providing grand spacial ambiance.

Like in all of our residences, you can enjoy great comfort in the interiors with the delightful ocean breeze thanks to the cross ventilation of the windows as well as the spacious open concept living area.



# THE MAGNIFICENT

TOTAL AREA: 1,785.19 ft<sup>2</sup> / 165.85 m<sup>2</sup>

INTERIOR AREA: 1,391.66 ft<sup>2</sup> / 129.29 m<sup>2</sup>

TERRACE: 393.53 ft<sup>2</sup> / 36.56 m<sup>2</sup>

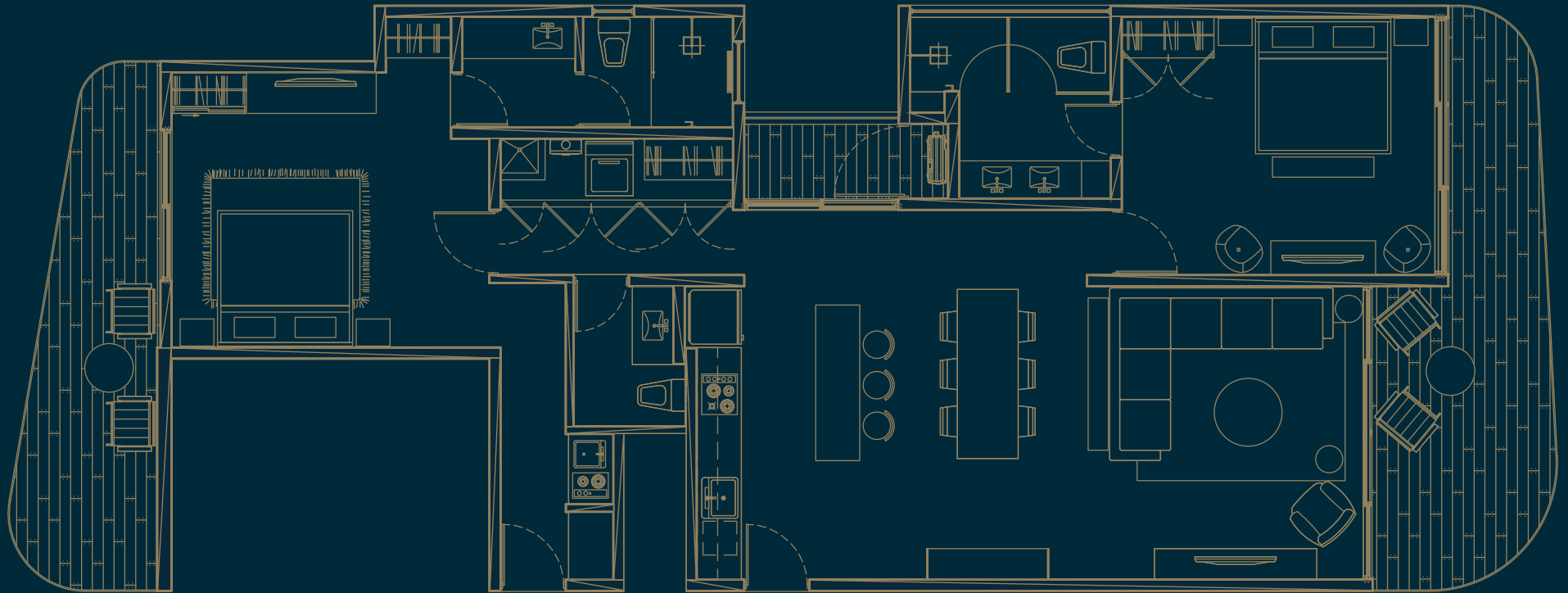

THREE BEDROOMS



LIVING ROOM



LAUNDRY SYSTEM



TWO FULL BATHS



DINING ROOM



TWO TERRACES



ONE HALF BATH



FULL KITCHEN



OCEAN VIEW

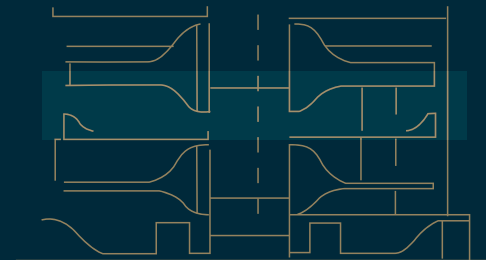





LET NATURE COLOR YOUR DAYS

# THE LUMINOUS RESIDENCE

## PENTHOUSE LEVEL

Touch the sky in our most luxurious and exclusive residences.

Breathtaking sunrises and extraordinary ocean views can be enjoyed from their own spacious sun deck with private pool.

Open space concept, two or three bedroom Penthouse residences with next level sophistication and style.



# THE LUMINOUS

TOTAL AREA: 1,595.98 ft<sup>2</sup> / 148.55 m<sup>2</sup>

INTERIOR AREA: 1,299.96 ft<sup>2</sup> / 120.77 m<sup>2</sup>

TERRACE: 299.02 ft<sup>2</sup> / 27.78 m<sup>2</sup>

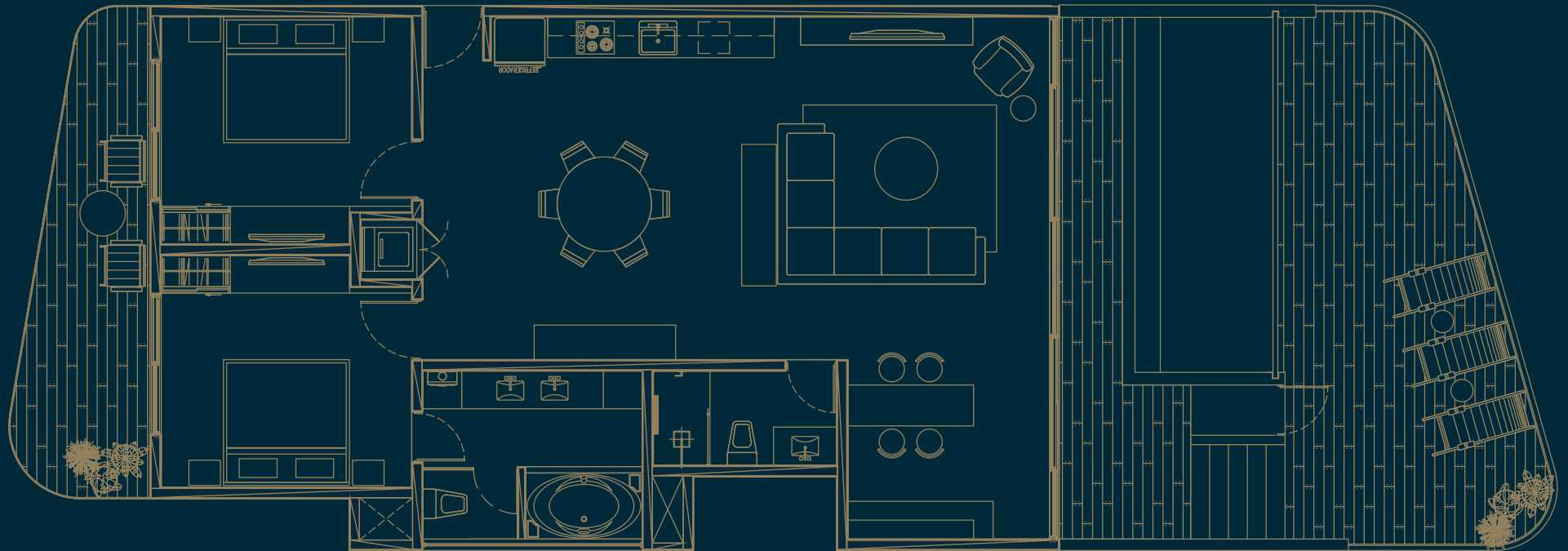

THREE BEDROOMS



LIVING ROOM



TWO FULL BATHS



DINING ROOM



ONE HALF BATH



FULL KITCHEN



LAUNDRY SYSTEM



TWO TERRACES



OCEAN VIEW



SUN DECK



PRIVATE POOL

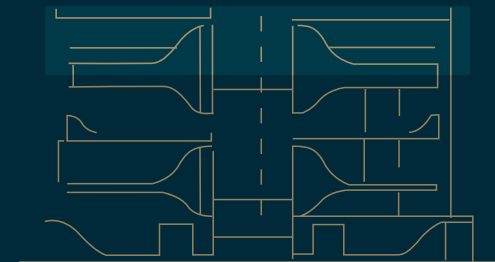

YOUR HAPPY PLACE AWAITS



\*IMAGES & RENDERS ARE FOR ILLUSTRATIVE PURPOSES

TANKAH  
— 52 —

[www.tankah52.com](http://www.tankah52.com)

---

TULUM BEACHFRONT RESIDENCES

---

DEVELOPMENT

COTA  
DESARROLLOS

ARCHITECTURE



INTERIORISM



BRANDING

PINK PEPPER  
EST. PROJECT 2011