



# Disponibilidad Oficinas Nido

*Octubre 2020*



# Nivel 3

Oficinas de 50 m<sup>2</sup> a 150 m<sup>2</sup>

| Nivel 3     |                         |         |
|-------------|-------------------------|---------|
| No. Oficina | m <sup>2</sup> Interior | Cajones |
| N3-01       | 98.24                   | 3       |
| N3-02       | 117.94                  | 4       |
| N3-03       | 124.78                  | 4       |
| N3-04       | 123.65                  | 4       |
| N3-05       | 109.95                  | 4       |
| N3-06       | 52.60                   | 2       |
| N3-07       | 52.10                   | 2       |
| N3-08       | 42.07                   |         |
| N3-09       | 73.50                   | 2       |
| N3-10       | 66.68                   | 2       |
| N3-11       | 103.98                  | 3       |
| N3-12       | 140.33                  | 5       |
| N3-13       | 135.58                  | 5       |
| N3-14       | 117.47                  | 4       |
| N3-15       | 142.94                  | 5       |
| N3-16       | 154.60                  | 5       |
| N3-17       | 142.18                  | 5       |
| N3-18       | 118.85                  | 4       |
| N3-19       | 80.93                   | 3       |
| N3-20       | 92.42                   | 3       |

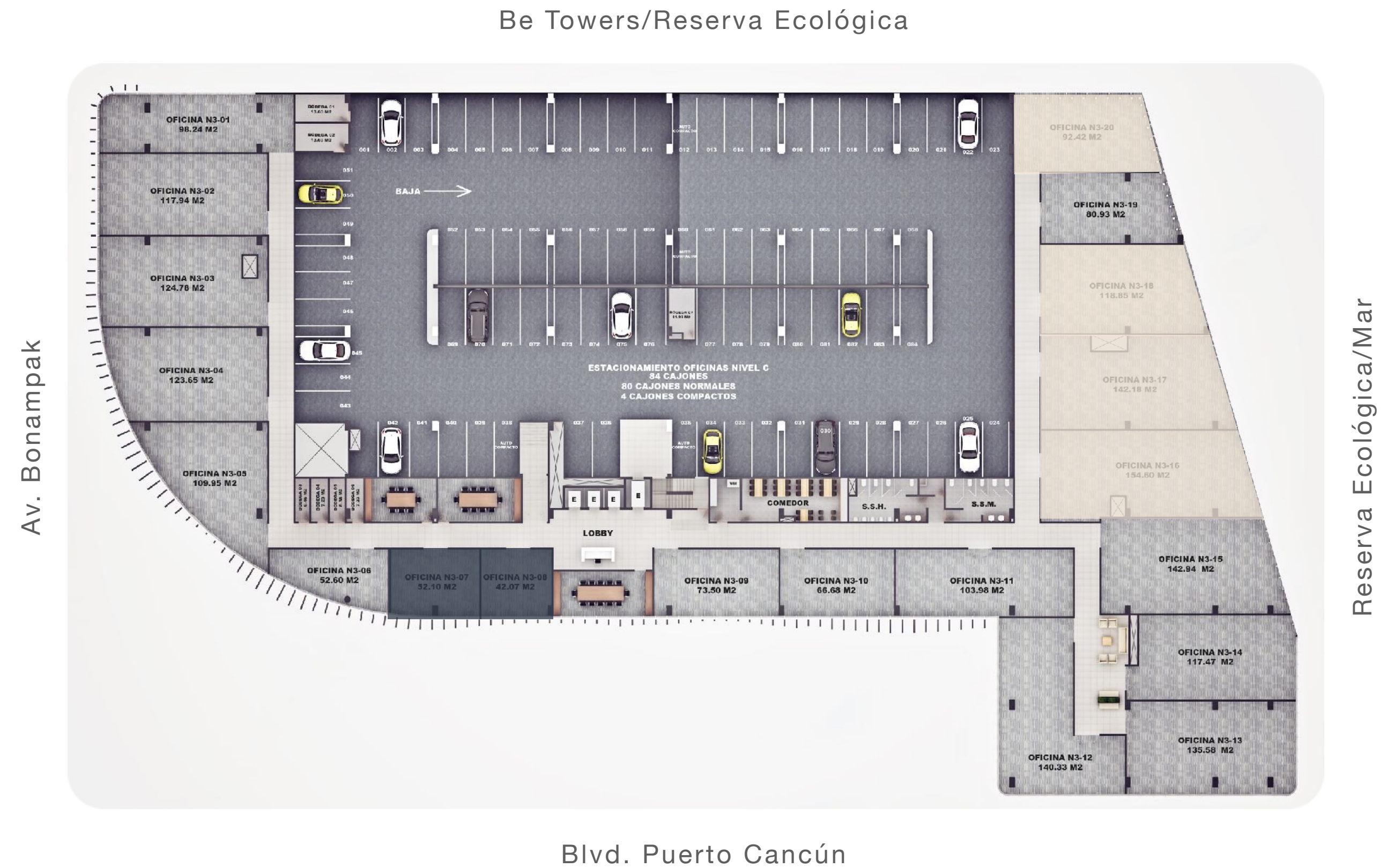

- Oficinas Vendidas
- Oficinas Separadas

# Nivel 4

Oficinas de 150 m<sup>2</sup> a 650 m<sup>2</sup>

| Nivel 4     |                         |         |
|-------------|-------------------------|---------|
| No. Oficina | m <sup>2</sup> Interior | Cajones |
| N4-01       |                         |         |
| N4-02       | 279.41                  | 9       |
| N4-03       | 175.04                  | 6       |
| N4-04       | 161.36                  | 5       |
| N4-05       | 183.68                  | 6       |
| N4-06       |                         |         |
| N4-07       |                         |         |
| N4-08       | 224.77                  | 7       |
| N4-09       |                         |         |
| N4-10       | 187.04                  | 6       |
| N4-11       |                         |         |
| N4-12       |                         |         |
| N4-13       |                         |         |
| N4-14       | 327.38                  | 11      |

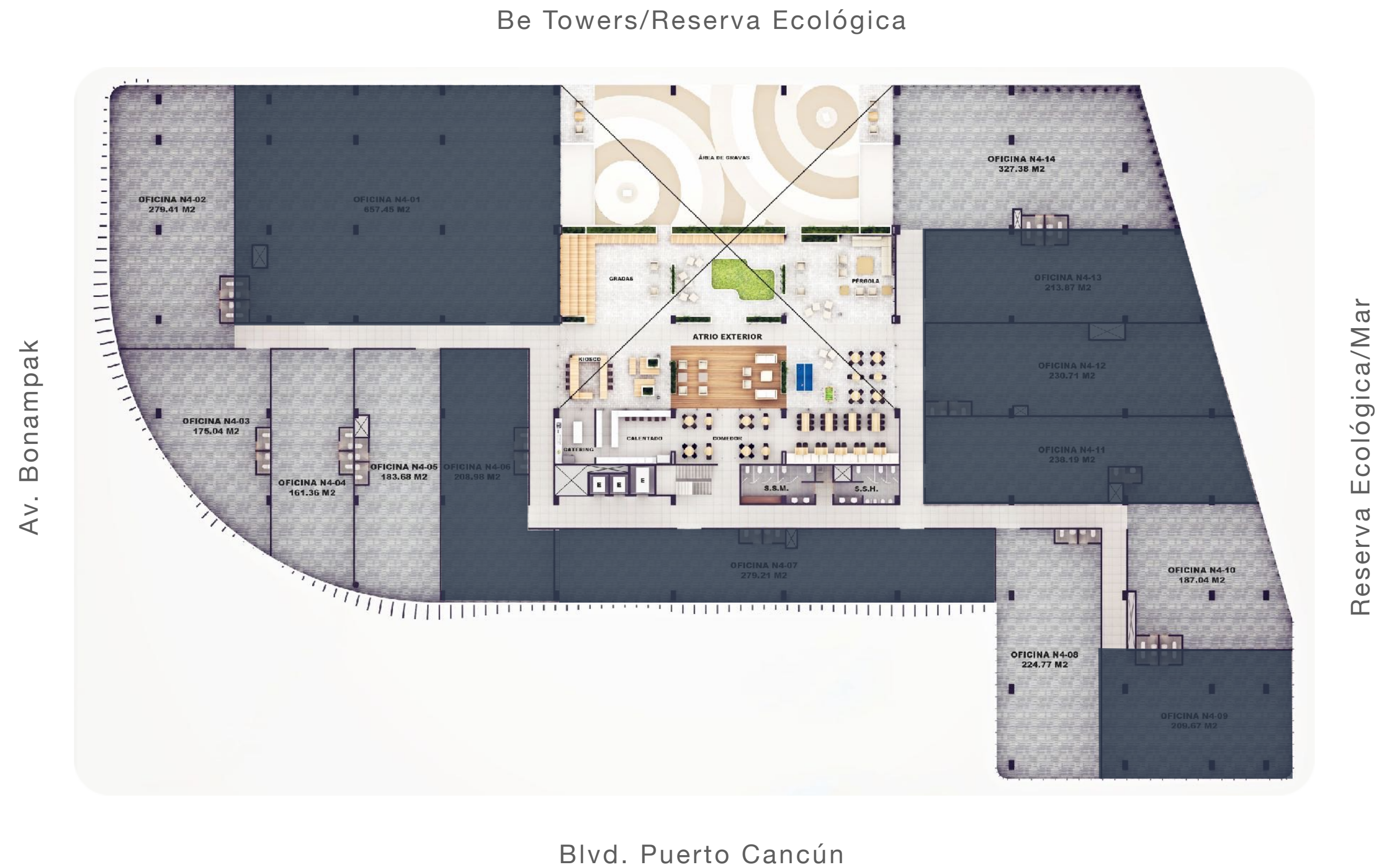

- Oficinas Vendidas
- Oficinas Separadas

# Nivel 5

Oficinas de 150 m<sup>2</sup> a 650 m<sup>2</sup>

| Nivel 5     |                         |         |
|-------------|-------------------------|---------|
| No. Oficina | m <sup>2</sup> Interior | Cajones |
| N5-01       |                         |         |
| N5-02       |                         |         |
| N5-03       |                         |         |
| N5-04       | 343.03                  | 11      |
| N5-05       | 175.04                  | 6       |
| N5-06       | 161.36                  | 5       |
| N5-07       | 183.68                  | 6       |
| N5-08       | 209.50                  | 7       |
| N5-09       | 144.38                  | 5       |
| N5-10       |                         |         |
| N5-11       |                         |         |
| N5-12       | 157.37                  | 5       |
| N5-13       | 159.46                  | 5       |
| N5-14       |                         |         |
| N5-15       |                         |         |
| N5-16       |                         |         |
| N5-17       |                         |         |

Be Towers/Reserva Ecológica



Bldv. Puerto Cancún

- Oficinas Vendidas
- Oficinas Separadas

